

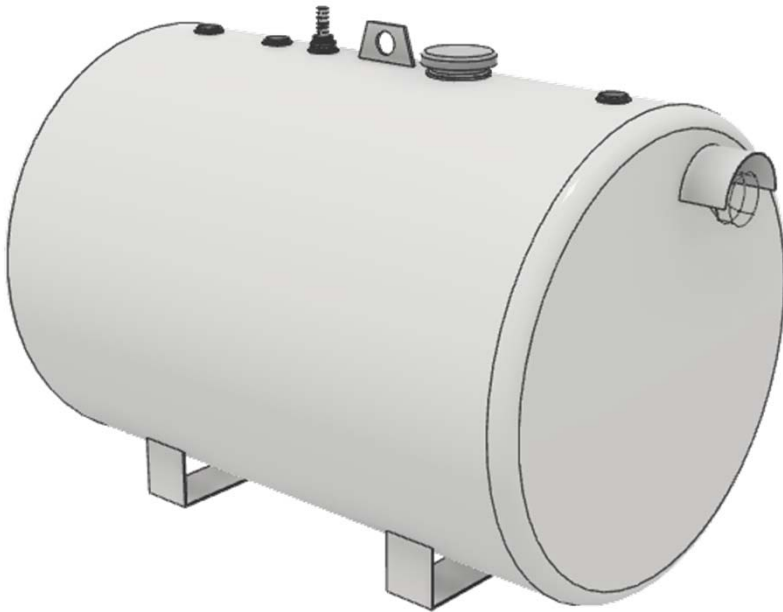

Double wall horizontal round steel utility tanks come standard with a 340° wrap and are continually monitored by a vacuum gauge installed in the head of the tank. A vacuum is pulled in the area between the primary and outer tanks at the time of manufacturer and a vacuum gauge is installed to monitor for leaks. No vacuum or low vacuum indicates the tank has a leak. Full vacuum indicates there are no leaks.

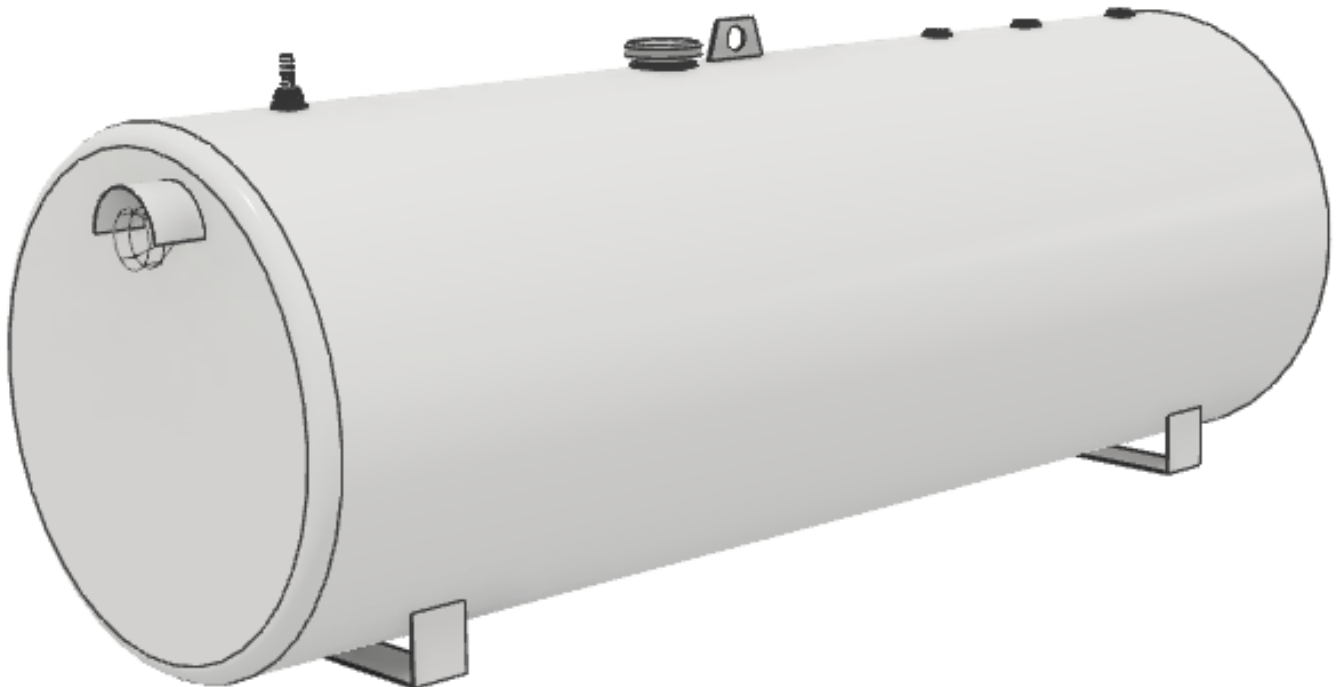

Tanks come standard with;
Lifting lug
Emergency vents for the primary tank
and for the interstice
2 – 2" NPT(f) top ports
1 – 1 ½" NPT(f) top port
1 – 1" NPT(f) drain port
Note: additional ports can be ordered.
Standard finish is White Enamel
Others colours can be ordered.



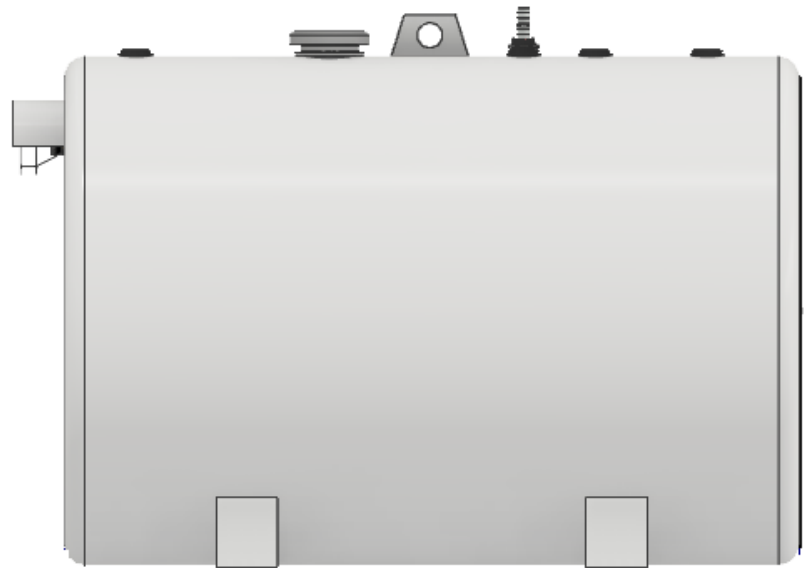
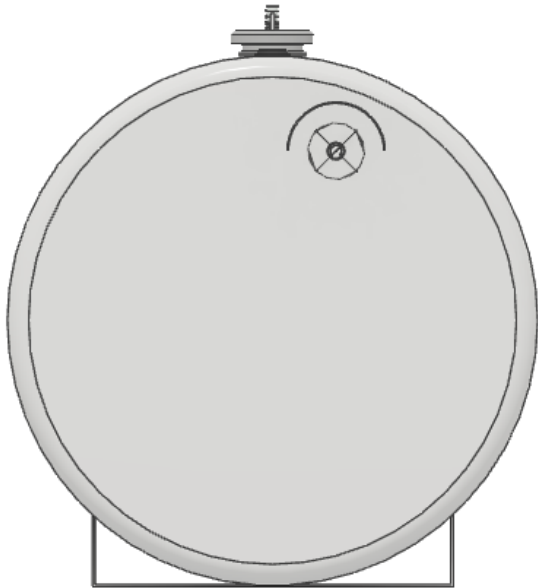

Material Gauge	Capacity	Diameter	Length	Weight
14	450 Liters	30"	48"	250 lbs
14	1,100 Liters	38"	60"	450 lbs
14	1,360 Liters	38"	72"	900 lbs
12	2,200 Liters	50"	72"	1,100 lbs
12	4,500 Liters	50"	144"	2,200 lbs

Options

Additional and various size ports.

Tank gauges, alarm, level monitors, heaters, pumping systems.

Premium coating

Interior linings

Available in a variety of sizes other than those listed above.