



Applied
Lubrication
Technology Inc.

12 French Drive
Mono, ON L9W 5W1
Sales Associate: Bob Lewis
Cell: (519) 658-3204
E-Mail: bob@promarkindustrials.ca
www.promarkindustrials.ca



HOSE REELS

INDEX

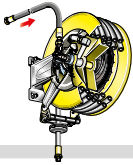

Hose reel advantages

page **3**



Air-Water Antifreeze hose reels - 300 psi

page **9**



Hot water hose reels - 1400 psi

page **10**



Hot water hose reels - 3000 psi

page **11**



Oil and similar hose reels - 2000 psi

page **12**



Grease hose reels - 5800 psi

page **13**



Diesel fuel hose reels - 140 psi

page **14**



Welding hose reels - 250 psi

page **15**



Series 430 ABS

page **16**



Series 260-280 ABS and 450 enclosed hose reels

page **17**



Series 436 - 537 DEF

page **19**



Series 350 grounding reels

page **20**



Series 617-637-618-638 motor-operated hose reels

page **21**



Accessories

page **23**

Applications

page **27**



- Quick and safe hose rewinding
- Workplace always in order
- It's a safeguards against wear and possible breakage of the hoses themselves
- Operators work in total security in a clean and tidy place
- The hose reels without hose have a swivelling female connection on the drum to facilitate hose mounting



When choosing a hose reel, it is important to consider the following aspects:

Type of fluid to be delivered

Flowrate in gpm. to be delivered

Length and diameter of hose to be used

Pressure of fluid

Air-water Antifreeze **300 psi**

Hot water **1400 psi**

Hot water **3000 psi**

Oil and similar **2000 psi**

Grease **5800 psi**

Diesel oil **140 psi**

Waste oil-diesel fuel **300 psi** (suction/delivery)

Welding gas **250 psi**

DEF **140 psi**

CHOOSING A HOSE REELS FOR CAPACITY

The following table gives the max length of those to be wound on our reels basing on external diameter of hose to be used:

Industrial series (open and enclosed)

External diameter of hose to be used	Hose reel spring rewinding capacity	Series	External diameter of hose to be used	Hose reel spring rewinding capacity	Series
ø 0.47"	max 52'	Series 290	ø 0.73"	max 92'	Series 530
ø 0.55"	max 45'		ø 0.79"	max 85'	
ø 0.63"	max 35'		ø 0.87"	max 75'	
ø 0.47"	max 60'	Series 330	ø 0.87"	max 100'	S. 540 outlet 3/8"
ø 0.55"	max 52'		ø 1.10"	max 72'	Series 540 outlet 1"
ø 0.63"	max 40'		ø 1.34"	max 55'	
ø 0.47"	max 72'	Series 390	ø 0.87"	max 200'	S. 560 outlet 3/8"
ø 0.55"	max 65'		ø 1.10"	max 130'	Series 560 outlet 1"
ø 0.63"	max 60'		ø 1.34"	max 100'	
ø 0.67"	max 70'	Series 430 Series 450			
ø 0.77"	max 52'				
ø 0.87"	max 45'				

Industrial series for double hose for welding

External diameter of hose to be used	Hose reel spring rewinding capacity	Series	External diameter of hose to be used	Hose reel spring rewinding capacity	Series
ø 0.51" x 0.51"	max 42'	Series 430	ø 0.51" x 0.51"	max 120'	Series 540
ø 0.59" x 0.59"	max 40'		ø 0.59" x 0.59"	max 115'	
ø 0.63" x 0.63"	max 35'		ø 0.63" x 0.63"	max 90'	
ø 0.51" x 0.51"	max 72'	Series 530			
ø 0.59" x 0.59"	max 65'				
ø 0.63" x 0.63"	max 50'				

Industrial motor-operated series

External diameter of hose to be used	Hose reel spring rewinding capacity	Series	External diameter of hose to be used	Hose reel spring rewinding capacity	Series
ø 0.79"	max 165'	Series 617 Series 618 outlet 1"	ø 0.79"	max 320'	Series 637 Series 638 outlet 1"
ø 1.06"	max 100'		ø 1.06"	max 200'	
ø 1.38"	max 65'		ø 1.38"	max 130'	
ø 1.06"	max 100'	8617.600-55 outlet 1-1/2"	ø 1.06"	max 200'	8637.600-55 outlet 1-1/2"
ø 1.38"	max 65'		ø 1.38"	max 130'	
ø 1.73"	max 50'		ø 1.73"	max 100'	
ø 1.97"	max 35'		ø 1.97"	max 65'	

HOSE REELS INSTALLATION

The hose reels are supplied with adjustable arms fitted as shown in the photo.

The same arms can be easily repositioned as required look the following options:



Wall installation with hose downwards. Ideal for use with drip-catcher tray.

1

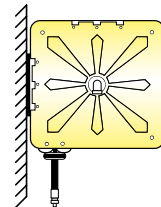
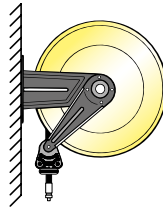

Wall installation with hose downwards. From the standard position turn the arms upwards, then turn the hose reel upside-down (see figure). Ideal for use of swivelling hose reels.

2

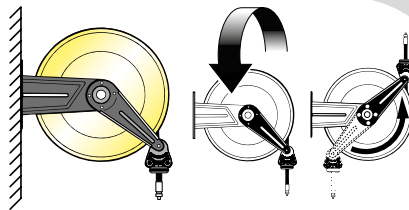

Wall installation with horizontal hose position. Ideal for mounting at medium/low heights.

3

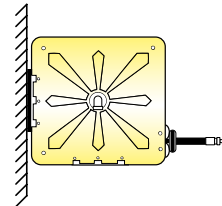
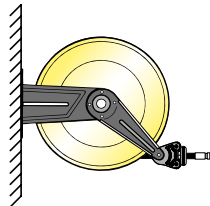

Bench installation.

4

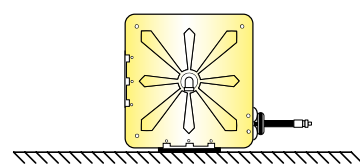
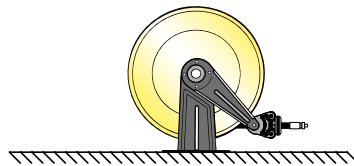

Ceiling installation.

5

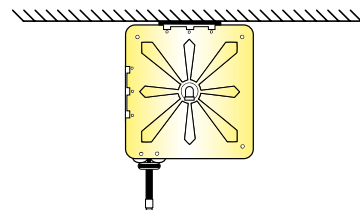
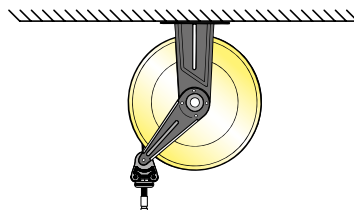

HOSE REELS TECHNICAL FEATURES

Hose reel outlet hose connection

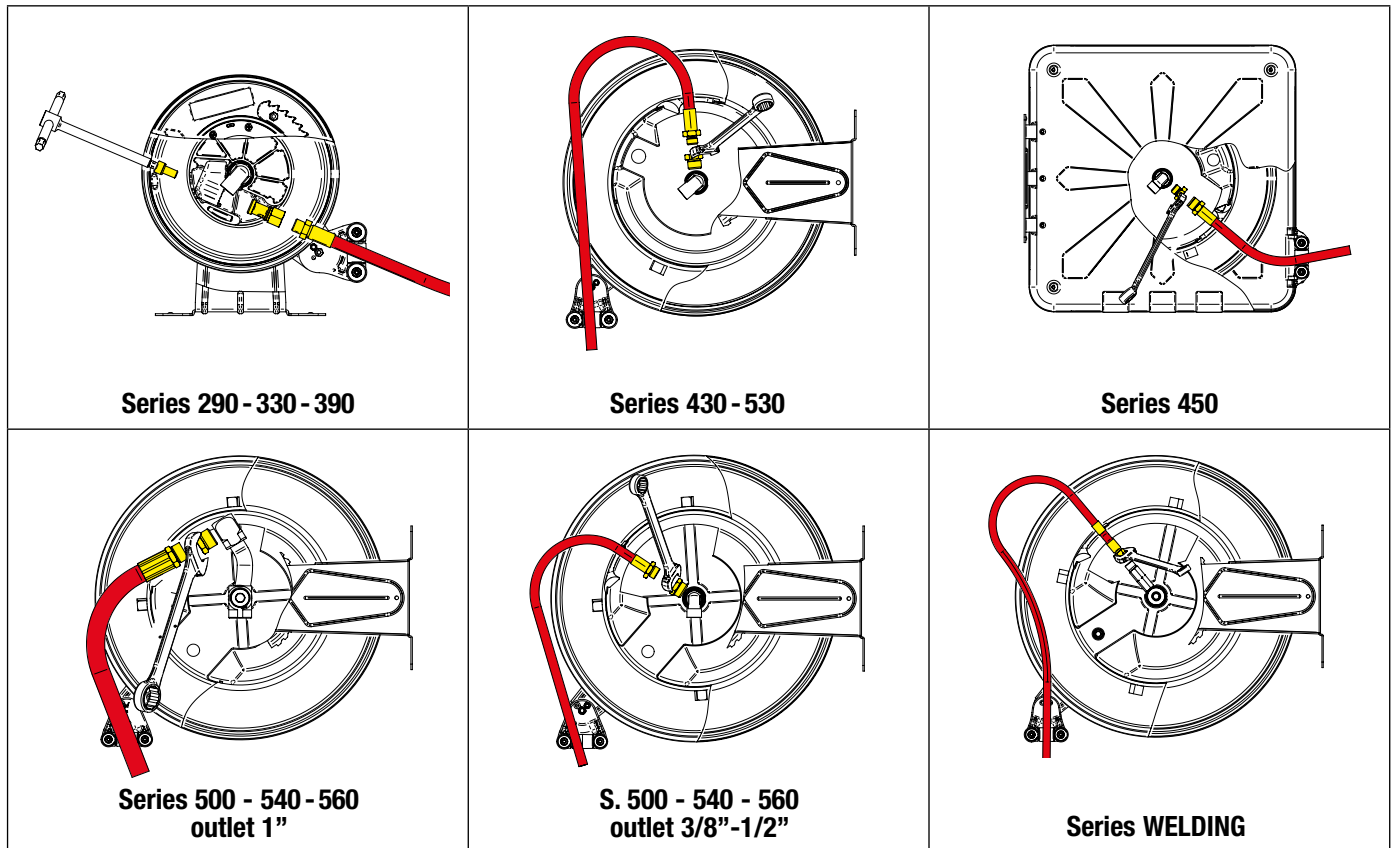

Universal hose stop

Adapters for hoses of different diameter
(Supplied with the hose stop)

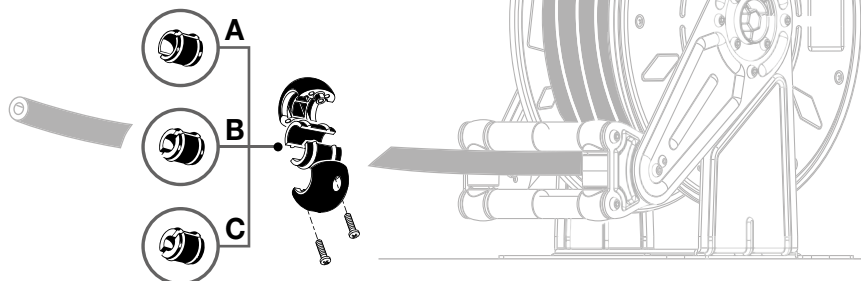

Comes with all hose reels supplied without hose, complete with adapters for using hoses of different diameter.

P/N	Series		Ø Reductions
KR7201	painted - stainless steel	290 - 330 - 390	0.47" - 0.55" - 0.63"
KR8104	painted - stainless steel	430 - 450 - 530	0.55" - 0.67" - 0.75"
KR8811	painted - stainless steel	540 outlet 1" - 560 outlet 1"	0.99" - 1.36"
KR8705	painted - stainless steel	500 - 540 - 560	0.55"-0.96"-0.83"-0.97"-1.10"-1.18"-1.34"
KR8907	painted	430 welding - 530 welding - 540 welding	0.47" - 0.55" - 0.59" - 0.63"

TECHNICAL CHARACTERISTICS

Enclosed hose reel Series 260

Automatic stopping system: allows hose to be locked at the required length

Fluid conveyance joint

The wall bracket with bayonet hooking is easy to mount and allows to remove quickly the hose reel when necessary

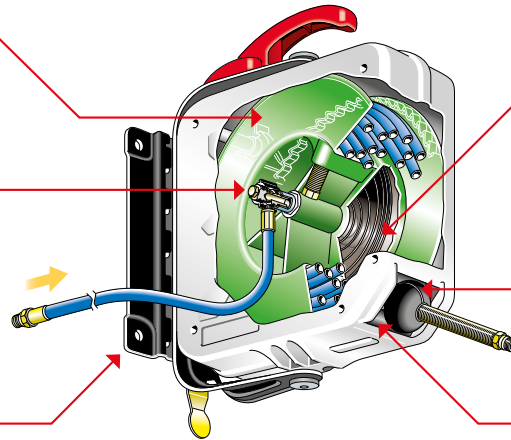

Rewinding spring

Adjustable hose stop

Self-lubricating hose guide rollers

Enclosed hose reel Series 450

Drum support bushings in self-lubricating material

The easy to install adjustable bracket allows the hose reel to be removed for any maintenance

The trip enables automatic stopping at the required length

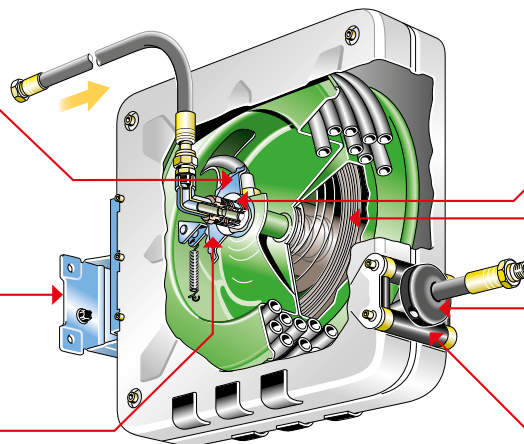

Fluid conveyance joint

Rewinding spring

Adjustable hose stop

Self-lubricating hose guide rollers

Hose reel

Automatic stopping system: allows the hose to be locked at the required length

Adjustable double arms: to favour hose extraction according to hose reel installation

Self-lubricating hose guide rollers: wide multi-way opening

Adjustable hose stop

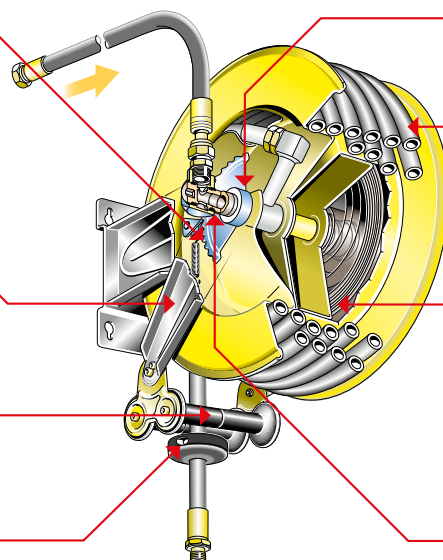

Drum support bushings in brass alloy, self-lubricating, effective and corrosion resistant

Hose reel drum: sturdy and practical with ribbing and rounded edges

Fully enclosed and protected constant-force automatic rewinding spring

Fluid passage swivel joint in brass / carbon steel / s/steel / AISI 304 s/steel with polyurethane / Viton® / Teflon® seals

HOSE REELS SERIES

Painted steel

Stainless steel

Series 290

Series 330

Series 390

Series 430

Series 430 ABS

Series 530

Series 540

Series 560





AIR-WATER ANTIFREEZE HOSE REELS - 300 PSI



Applied
Lubrication
Technology Inc.



Hose reels with
hoses in black
synthetic rubber
and zinc plated
steel fittings.



The hose reels are equipped with a universal
hose stop; those with hose are provided with
a 2' inlet connection hose.

Seals are in **Viton®**
Swivel joint in **Brass**

	P/N	P/N	Delivery hose			Inlet connection	Outlet connection
	PAINTED STEEL	AISI 304 STAINLESS STEEL	Ø	length	P/N hose		
Series 290	8290.100-55	8292.100-55	without hose			3/8"NPSM (f)	3/8"NPTF (f)
	8290.101-55	-	3/8"	35'	995.210-55	3/8"NPTF (m)	3/8"NPTF (m)
	8290.102-55	-	1/4"	50'	993.215-55	3/8"NPTF (m)	1/4"NPTF (m)
Series 330	8330.100-55	8332.100-55	without hose			3/8"NPSM (f)	3/8"NPTF (f)
	8330.101-55	-	3/8"	40'	995.211-55	3/8"NPTF (m)	3/8"NPTF (m)
	8330.102-55	-	1/4"	60'	993.218-55	3/8"NPTF (m)	1/4"NPTF (m)
Series 390	8390.100-55	8392.100-55	without hose			3/8"NPSM (f)	3/8"NPTF (f)
	8390.101-55	-	3/8"	40'	995.211-55	3/8"NPTF (m)	3/8"NPTF (m)
	8390.102-55	-	3/8"	60'	995.217-55	3/8"NPTF (m)	3/8"NPTF (m)
Series 430	8430.100-55	8432.100-55	without hose			1/2"NPSM (f)	1/2"NPSM (f)
	8430.101-55	-	3/8"	40'	995.211-55	1/2"NPTF (m)	3/8"NPTF (m)
	8430.102-55	-	3/8"	60'	995.217-55	1/2"NPTF (m)	3/8"NPTF (m)
	8430.103-55	-	1/2"	35'	996.210-55	1/2"NPTF (m)	1/2"NPTF (m)
	8430.104-55	-	1/2"	50'	996.215-55	1/2"NPTF (m)	1/2"NPTF (m)
Series 530	8530.100-55	8532.100-55	without hose			1/2"NPSM (f)	1/2"NPSM (f)
	8530.101-55	-	1/2"	65'	996.220-55	1/2"NPTF (m)	1/2"NPTF (m)
	8530.102-55	-	1/2"	80'	996.225-55	1/2"NPTF (m)	1/2"NPTF (m)
Series 540	8540.100-55	8542.100-55	without hose			1"NPSM (f)	1"NPSM (f)
	8540.101-55	-	3/4"	50'	997.215-55	1"NPTF (m)	3/4"NPTF (m)
	8540.102-55	-	3/4"	65'	997.220-55	1"NPTF (m)	3/4"NPTF (m)
	8540.103-55	-	1"	50'	998.215-55	1"NPTF (m)	1"NPTF (m)
Series 560	8560.100-55	8562.100-55	without hose			1"NPSM (f)	1"NPSM (f)
	8560.101-55	-	3/4"	100'	997.230-55	1"NPTF (m)	3/4"NPTF (m)
	8560.103-55	-	3/4"	130'	997.240-55	1"NPTF (m)	3/4"NPTF (m)
	8560.104-55	-	1"	65'	998.220-55	1"NPTF (m)	1"NPTF (m)
	8560.105-55	-	1"	100'	998.230-55	1"NPTF (m)	1"NPTF (m)

Series	A	B	C	D	E	F	G	H	1 ft³	lb
290	5.5"	7.3"	7.7"	8.9"	4.3"	12.2"	11.8"	12.6"	1.3	22 ÷ 30
330	5.5"	7.3"	7.7"	8.9"	4.3"	14"	13.8"	14.4"	1.9	24 ÷ 33
390	5.5"	7.3"	7.7"	8.9"	4.3"	15.7"	15.3"	16.1"	2.4	28 ÷ 34
430	5.5"	7.3"	7.7"	8.9"	4.5"	18.1"	16.5"	18.1"	3.0	35 ÷ 46
530	6.0"	8.0"	8.6"	10.1"	4.5"	21.6"	20.0"	22.0"	5.0	48 ÷ 63
540	8.6"	11.8"	9"	10.5"	7.5"	21.6"	20.0"	22.6"	6.2	68 ÷ 85
560	15.7"	19.2"	9.3"	10.7"	14.5"	21.6"	20.0"	22.7"	10.9	112 ÷ 143

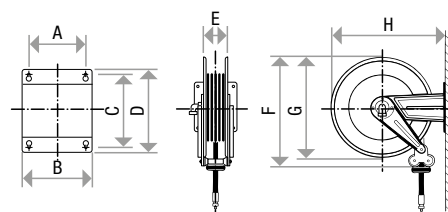



HOT WATER HOSE REELS - 1400 PSI



Applied
Lubrication
Technology Inc.



Hose reels with
hoses in black
synthetic rubber
and zinc plated
steel fittings.



The hose reels are equipped with a universal
hose stop; those with hose are provided with
a 2' inlet connection hose.

Seals are in **Viton®**
Swivel joint in **Stainless Steel**

	P/N	P/N	Delivery hose			Inlet connection	Outlet connection
	PAINTED STEEL	AISI 304 STAINLESS STEEL	Ø	length	P/N hose		
Series 330	8330.200-55	8332.200-55	without hose			1/2" NPSM (f)	3/8" NPTF (f)
	8330.201-55	-	3/8"	40'	995.313-55	1/2" NPTF (m)	3/8" NPTF (m)
	8330.202-55	-	1/2"	25'	996.307-55	1/2" NPTF (m)	1/2" NPTF (m)
Series 390	8390.200-55	8392.200-55	without hose			1/2" NPSM (f)	3/8" NPTF (f)
	8390.201-55	-	3/8"	40'	995.313-55	1/2" NPTF (m)	3/8" NPTF (m)
	8390.202-55	-	3/8"	56'	995.318-55	1/2" NPTF (m)	3/8" NPTF (m)
Series 430	8430.200-55	8434.200-55	without hose			1/2" NPSM (f)	1/2" NPSM (f)
	8430.201-55	-	1/2"	35'	996.311-55	1/2" NPTF (m)	1/2" NPTF (m)
	8430.202-55	-	1/2"	50'	996.316-55	1/2" NPTF (m)	1/2" NPTF (m)
Series 530	8530.200-55	8534.200-55	without hose			1/2" NPSM (f)	1/2" NPSM (f)
	8530.201-55	-	1/2"	65'	996.321-55	1/2" NPTF (m)	1/2" NPTF (m)
	8530.202-55	-	1/2"	80'	996.326-55	1/2" NPTF (m)	1/2" NPTF (m)
Series 540	8540.200-55	8544.200-55	without hose			1" NPSM (f)	1" NPSM (f)
	8540.201-55	-	3/4"	50'	997.315-55	1" NPTF (m)	3/4" NPTF (m)
	8540.202-55	-	3/4"	65'	997.320-55	1" NPTF (m)	3/4" NPTF (m)
	8540.203-55	-	1"	50'	998.315-55	1" NPTF (m)	1" NPTF (m)
Series 560	8560.200-55	8564.200-55	without hose			1" NPSM (f)	1" NPSM (f)
	8560.201-55	-	3/4"	100'	997.330-55	1" NPTF (m)	3/4" NPTF (m)
	8560.203-55	-	3/4"	130'	997.340-55	1" NPTF (m)	3/4" NPTF (m)
	8560.204-55	-	1"	65'	998.320-55	1" NPTF (m)	1" NPTF (m)
	8560.205-55	-	1"	100'	998.330-55	1" NPTF (m)	1" NPTF (m)

INSTALLATION

The template
supplied
facilitates
drilling of the
holes and
therefore hose
reel fixing

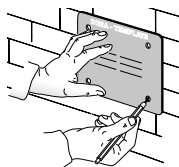

The quick coupling
adjustable
support
that enables
40° rotation
to the right
or left of the
hose reel is available on request

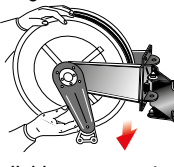

The adjustable
arms can be
easily
repositioned
according to
needs

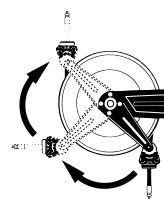

For installing several hose reels in
series, follow the distance
between bracket and
bracket as per drawing
in order to keep
them aligned with
eventual drip-catchers
assembled underneath

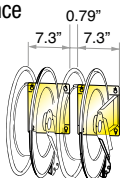

Series	A	B	C	D	E	F	G	H	1 ft³	lb
330	5.5"	7.3"	7.7"	8.9"	4.3"	14"	13.8"	14.4"	1.9	24 ÷ 31
390	5.5"	7.3"	7.7"	8.9"	4.3"	15.7"	15.3"	16.1"	2.4	28 ÷ 37
430	5.5"	7.3"	7.7"	8.9"	4.5"	18.1"	16.5"	18.1"	3.0	35 ÷ 49
530	6.0"	8.0"	8.6"	10.1"	4.5"	21.6"	20.0"	22.0"	5.0	48 ÷ 70
540	8.6"	11.8"	9"	10.5"	7.5"	21.6"	20.0"	22.6"	6.2	65 ÷ 97
560	15.7"	19.2"	9.3"	10.7"	14.5"	21.6"	20.0"	22.7"	10.9	110 ÷ 176

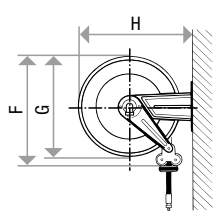
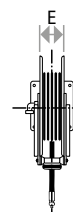
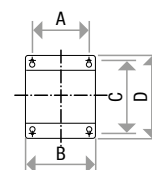



HOT WATER HOSE REELS - 3000 PSI



Applied
Lubrication
Technology Inc.



Hose reels with
hoses in black
synthetic rubber
and zinc plated
steel fittings.



The hose reels are equipped with a universal
hose stop; those with hose are provided with
a 2' inlet connection hose.

Seals are in **Viton®**
Seals are in **Teflon®** for water 5800 psi
Swivel joint in **Stainless Steel**

	P/N	P/N	Delivery hose			Inlet connection	Outlet connection
	PAINTED STEEL	AISI 304 STAINLESS STEEL	Ø	length	P/N hose		
Series 330	8330.300-55	8332.300-55	without hose			3/8"NPSM (f)	3/8"NPTF (f)
	8330.301-55	-	5/16"	40'	994.512-55	3/8"NPTF (m)	3/8"NPTF (f)
Series 390	8390.300-55	8392.300-55	without hose			3/8"NPSM (f)	3/8"NPTF (f)
	8390.301-55	-	5/16"	40'	994.512-55	3/8"NPTF (m)	3/8"NPSM (f)
	8390.302-55	-	5/16"	56'	994.517-55	3/8"NPTF (m)	3/8"NPSM (f)
Series 430	8430.300-55	8434.300-55	without hose			3/8"NPSM (f)	3/8"NPSM (f)
	8430.301-55	-	3/8"	40'	995.512-55	3/8"NPTF (m)	3/8"NPSM (f)
	8430.302-55	-	3/8"	60'	995.518-55	3/8"NPTF (m)	3/8"NPSM (f)
Series 530	8530.300-55	8534.300-55	without hose			3/8"NPSM (f)	3/8"NPSM (f)
	8530.301-55	-	3/8"	65'	995.520-55	3/8"NPTF (m)	3/8"NPSM (f)
	8530.302-55	-	3/8"	80'	995.525-55	3/8"NPTF (m)	3/8"NPSM (f)
Series 530 5800 psi	8530.350-55	8534.350-55	without hose			3/8"NPSM (f)	3/8"NPSM (f)
Series 540	8540.300-55	8544.300-55	without hose			3/8"NPSM (f)	3/8"NPSM (f)
	8540.301-55	-	3/8"	100'	995.530-55	3/8"NPTF (m)	3/8"NPSM (f)
Series 560	8560.300-55	8564.300-55	without hose			3/8"NPSM (f)	3/8"NPSM (f)
	8560.301-55	-	3/8"	130'	995.540-55	3/8"NPTF (m)	3/8"NPSM (f)
	8560.302-55	-	3/8"	165'	995.550-55	3/8"NPTF (m)	3/8"NPSM (f)

INSTALLATION

The template
supplied
facilitates
drilling of the
holes and
therefore hose
reel fixing

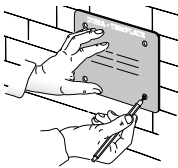

The quick coupling
adjustable
support
that enables
40° rotation
to the right
or left of the
hose reel is available on request

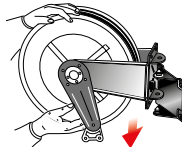

The adjustable
arms can be
easily
repositioned
according to
needs

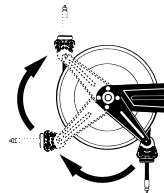

For installing several hose reels in
series, follow the distance
between bracket and
bracket as per drawing
in order to keep
them aligned with
eventual drip-catchers
assembled underneath

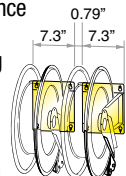

Series	A	B	C	D	E	F	G	H	1 ft³	lb
330	5.5"	7.3"	7.7"	8.9"	4.3"	14"	13.8"	14.4"	1.9	26 ÷ 32
390	5.5"	7.3"	7.7"	8.9"	4.3"	15.7"	15.3"	16.1"	2.4	30 ÷ 40
430	5.5"	7.3"	7.7"	8.9"	4.5"	18.1"	16.5"	18.1"	3.0	36 ÷ 49
530	6.0"	8.0"	8.6"	10.1"	4.5"	21.6"	20.0"	22.0"	5.0	50 ÷ 68
540	8.6"	11.8"	9"	10.5"	7.5"	21.6"	20.0"	22.6"	6.2	66 ÷ 83
560	15.7"	19.2"	9.3"	10.7"	14.5"	21.6"	20.0"	22.7"	10.9	113 ÷ 143

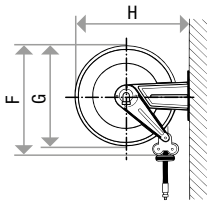
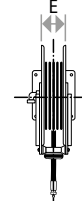
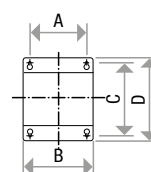



OIL AND SIMILAR HOSE REELS - 2000 PSI



Applied
Lubrication
Technology Inc.



Hose reels with
hoses in black
synthetic rubber
and zinc plated
steel fittings.



The hose reels are equipped with a universal
hose stop; those with hose are provided with
a 2' inlet connection hose.

Seals are in **PU**

Swivel joint is in **zinc plated steel** for the
painted steel version, and in **stainless steel**
for the stainless steel version

	P/N	P/N	Delivery hose			Inlet connection	Outlet connection
	PAINTED STEEL	AISI 304 STAINLESS STEEL	Ø	length	P/N hose		
Series 330	8330.400-55	8332.200-55	without hose			1/2"NPSM (f)	3/8"NPTF (f)
	8330.401-55	-	1/2"	25'	996.308-55	1/2"NPTF (m)	1/2"NPSM (f)
	8330.402-55	-	3/8"	40'	995.312-55	1/2"NPTF (m)	1/2"NPSM (f)
Series 390	8390.400-55	8392.200-55	without hose			1/2"NPSM (f)	3/8"NPTF (f)
	8390.401-55	-	3/8"	40'	995.312-55	1/2"NPTF (m)	1/2"NPTF (m)
	8390.402-55	-	3/8"	56'	995.317-55	1/2"NPTF (m)	1/2"NPTF (m)
Series 430	8430.400-55	8434.200-55	without hose			1/2"NPSM (f)	1/2"NPSM (f)
	8430.401-55	-	1/2"	35'	996.310-55	1/2"NPTF (m)	1/2"NPTF (m)
	8430.402-55	-	1/2"	50'	996.315-55	1/2"NPTF (m)	1/2"NPTF (m)
Series 530	8530.400-55	8534.200-55	without hose			1/2"NPSM (f)	1/2"NPSM (f)
	8530.401-55	-	1/2"	65'	996.320-55	1/2"NPTF (m)	1/2"NPTF (m)
	8530.402-55	-	1/2"	80'	996.325-55	1/2"NPTF (m)	1/2"NPTF (m)
Series 540 1400 psi	8540.400-55	8544.200-55	without hose			1"NPSM (f)	1"NPSM (f)
	8540.411-55	-	3/4"	50'	997.3315-55	1"NPTF (m)	3/4"NPTF (m)
	8540.412-55	-	3/4"	65'	997.3320-55	1"NPTF (m)	3/4"NPTF (m)
Series 540 725 psi	8540.413-55	-	1"	50'	998.3315-55	1"NPTF (m)	1"NPTF (m)
Series 560 1400 psi	8560.400-55	8564.200-55	without hose			1"NPSM (f)	1"NPSM (f)
	8560.411-55	-	3/4"	100'	997.530-55	1"NPTF (m)	3/4"NPTF (m)
	8560.413-55	-	3/4"	130'	997.540-55	1"NPTF (m)	3/4"NPTF (m)
Series 560 725 psi	8560.414-55	-	1"	65'	998.520-55	1"NPTF (m)	1"NPTF (m)
	8560.415-55	-	1"	100'	998.530-55	1"NPTF (m)	1"NPTF (m)

INSTALLATION

The template
supplied
facilitates
drilling of the
holes and
therefore hose
reel fixing

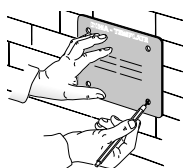

The quick coupling
adjustable
support
that enables
40° rotation
to the right
or left of the
hose reel is available on request

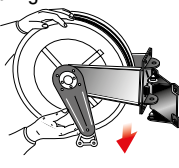

The adjustable
arms can be
easily
repositioned
according to
needs

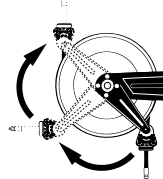

For installing several hose reels in
series, follow the distance
between bracket and
bracket as per drawing
in order to keep
them aligned with
eventual drip-catchers
assembled underneath

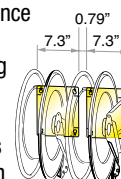

Series	A	B	C	D	E	F	G	H	1 ft ³	lb
330	5.5"	7.3"	7.7"	8.9"	4.3"	14"	13.8"	14.4"	1.9	28 ÷ 36
390	5.5"	7.3"	7.7"	8.9"	4.3"	15.7"	15.3"	16.1"	2.4	30 ÷ 42
430	5.5"	7.3"	7.7"	8.9"	4.5"	18.1"	16.5"	18.1"	3.0	37 ÷ 49
530	6.0"	8.0"	8.6"	10.1"	4.5"	21.6"	20.0"	22.0"	5.0	49 ÷ 69
540	8.6"	11.8"	9"	10.5"	7.5"	21.6"	20.0"	22.6"	6.2	65 ÷ 110
560	15.7"	19.2"	9.3"	10.7"	14.5"	21.6"	20.0"	22.7"	10.9	110 ÷ 158

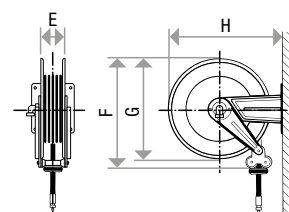
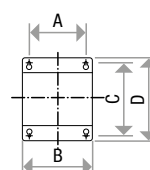



GREASE HOSE REELS - 5800 PSI



Applied
Lubrication
Technology Inc.



Hose reels with
hoses in black
synthetic rubber
and zinc plated
steel fittings.



The hose reels are equipped with a universal
hose stop; those with hose are provided with
a 2' inlet connection hose.

Seals are in **PU**

Swivel joint is in **zinc plated steel** for the
painted steel version, and in **stainless steel**
for the stainless steel version

	P/N	P/N	Delivery hose			Inlet connection	Outlet connection
	PAINTED STEEL	AISI 304 STAINLESS STEEL	Ø	length	P/N hose		
Series 330	8330.500-55	8332.500-55	without hose			3/8"NPSM (f)	3/8"NPTF (f)
	8330.501-55	-	1/4"	40'	993.511-55	3/8"NPTF (m)	1/4"NPTF (f)
Series 390	8390.500-55	8392.500-55	without hose			3/8"NPSM (f)	3/8"NPTF (f)
	8390.501-55	-	1/4"	40'	993.511-55	3/8"NPTF (m)	1/4"NPTF (m)
	8390.502-55	-	1/4"	52'	993.516-55	3/8"NPTF (m)	1/4"NPTF (m)
Series 430	8430.500-55	8432.500-55	without hose			3/8"NPSM (f)	3/8"NPSM (f)
	8430.501-55	-	1/4"	40'	993.511-55	3/8"NPTF (m)	1/4"NPTF (m)
	8430.502-55	-	1/4"	60'	993.518-55	3/8"NPTF (m)	1/4"NPTF (m)
	8430.505-55	-	3/8"	35'	995.710-55	3/8"NPTF (m)	1/4"NPTF (m)
	8430.506-55	-	3/8"	50'	995.715-55	3/8"NPTF (m)	1/4"NPTF (m)
Series 530	8530.500-55	8532.500-55	without hose			3/8"NPSM (f)	3/8"NPSM (f)
	8530.501-55	-	3/8"	65'	995.720-55	3/8"NPTF (m)	1/4"NPTF (m)
	8530.502-55	-	3/8"	80'	995.725-55	3/8"NPTF (m)	1/4"NPTF (m)

INSTALLATION

The template
supplied
facilitates
drilling of the
holes and
therefore hose
reel fixing

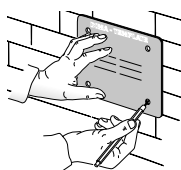

The quick coupling
adjustable
support
that enables
40° rotation
to the right
or left of the
hose reel is available on request

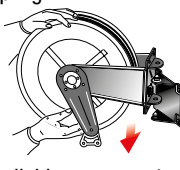

The adjustable
arms can be
easily
repositioned
according to
needs

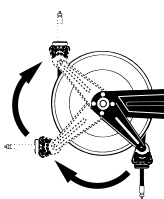

For installing several hose reels in
series, follow the distance
between bracket and
bracket as per drawing
in order to keep
them aligned with
eventual drip-catchers
assembled underneath

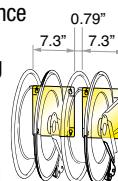

Series	A	B	C	D	E	F	G	H	1 ft³	lb
330	5.5"	7.3"	7.7"	8.9"	4.3"	14"	13.8"	14.4"	1.9	28 ÷ 33
390	5.5"	7.3"	7.7"	8.9"	4.3"	15.7"	15.3"	16.1"	2.4	30 ÷ 42
430	5.5"	7.3"	7.7"	8.9"	4.5"	18.1"	16.5"	18.1"	3.0	37 ÷ 52
530	6.0"	8.0"	8.6"	10.1"	4.5"	21.6"	20.0"	22.0"	5.0	50 ÷ 80

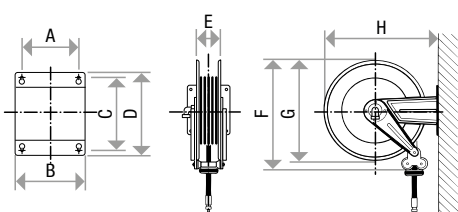



DIESEL FUEL HOSE REELS - 140 PSI



Applied
Lubrication
Technology Inc.



Hose reels with hoses in black synthetic rubber and zinc plated steel fittings.



The hose reels are equipped with a universal hose stop; those with hose are provided with a 2' inlet connection hose.

Seals are in **Viton®**

Swivel joint is in **zinc plated steel** for the painted steel version, and in **stainless steel** for the stainless steel version

	P/N	P/N	Delivery hose			Inlet connection	Outlet connection
	PAINTED STEEL	AISI 304 STAINLESS STEEL	Ø	length	P/N hose		
Series 530	8530.600-55	-	without hose			1" NPSM (f)	1" NPSM (f)
	8530.603-55	-	3/4"	40'	997.812-55	1" NPTF (m)	3/4" NPTF (m)
	8530.604-55	-	1"	25'	998.808-55	1" NPTF (m)	1" NPTF (m)
Series 540	8540.100-55	8542.100-55	without hose			1" NPSM (f)	1" NPSM (f)
	8540.601-55	-	3/4"	50'	997.815-55	1" NPTF (m)	3/4" NPTF (m)
	8540.602-55	-	3/4"	65'	997.820-55	1" NPTF (m)	3/4" NPTF (m)
	8540.603-55	-	1"	50'	998.815-55	1" NPTF (m)	1" NPTF (m)
Series 560	8560.100-55	8562.100-55	without hose			1" NPSM (f)	1" NPSM (f)
	8560.601-55	-	3/4"	100'	997.830-55	1" NPTF (m)	3/4" NPTF (m)
	8560.602-55	-	3/4"	115'	997.835-55	1" NPTF (m)	3/4" NPTF (m)
	8560.603-55	-	3/4"	130'	997.840-55	1" NPTF (m)	3/4" NPTF (m)
	8560.604-55	-	1"	65'	998.820-55	1" NPTF (m)	1" NPTF (m)
	8560.605-55	-	1"	100'	998.830-55	1" NPTF (m)	1" NPTF (m)

WASTE OIL-DIESEL FUEL - SUCTION/DELIVERY

	P/N	P/N	Delivery hose			Inlet connection	Outlet connection
	PAINTED STEEL	AISI 304 STAINLESS STEEL	Ø	length	P/N hose		
Series 430	8430.401/AS-55	-	1/2"	35'	996.310-55	1/2" NPTF (m)	1/2" NPTF (m)
	8430.450/AS-55	-	without hose			1" NPSM (f)	1" NPSM (f)
	8430.452/AS-55	-	3/4"	25'	997.3309-55	1" NPTF (m)	3/4" NPTF (m)
Series 540	8540.413/AS-55	-	1"	50'	998.815-55	1" NPTF (m)	1" NPTF (m)

Series	A	B	C	D	E	F	G	H	1 ft³	lb
430	5.5"	7.3"	7.7"	8.9"	4.5"	18.1"	16.5"	18.1"	3.0	46
530	6.0"	8.0"	8.6"	10.1"	4.5"	21.6"	20.0"	22.0"	5.0	48 ÷ 67
540	8.6"	11.8"	9"	10.5"	7.5"	21.6"	20.0"	22.6"	6.2	68 ÷ 90
560	15.7"	19.2"	9.3"	10.7"	14.5"	21.6"	20.0"	22.7"	10.9	110 ÷ 162

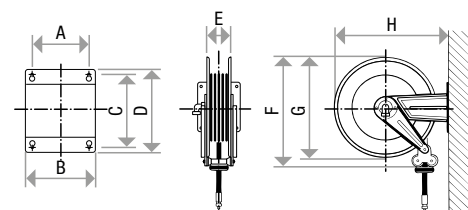



WELDING HOSE REELS - 250 PSI

Hose reels suitable for twin hose for welding with brass fittings.

The hose reels are equipped with a universal hose stop. Connections are left and right hand thread. (left hand for acetylene and right hand for oxygen).

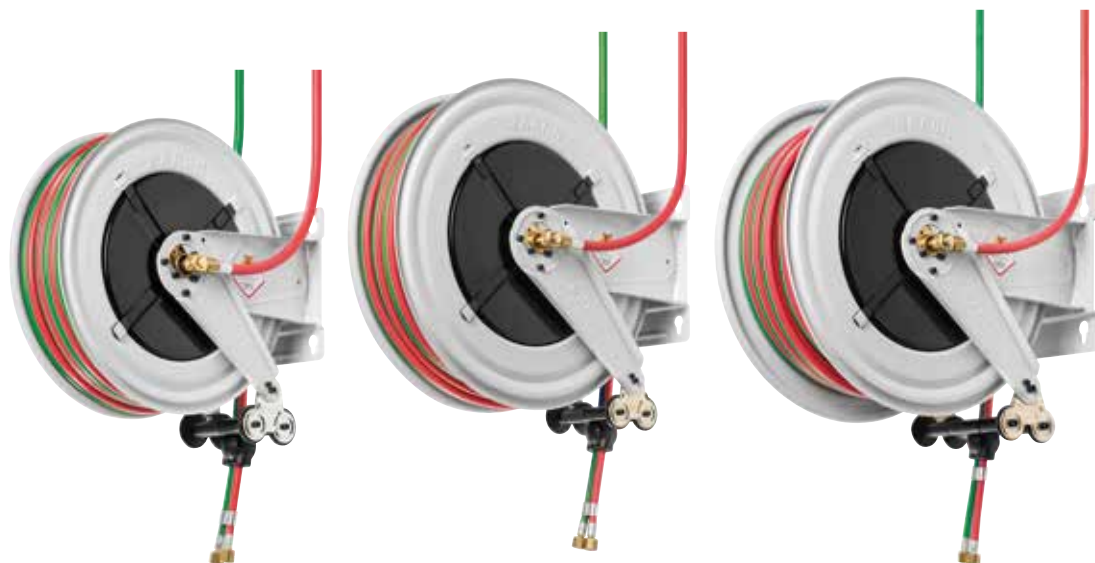

Note: all the hose reels are without hose

	P/N	Delivery hose	Inlet connection	Outlet connection
Series 430	8430.700-55	without hose	9/16"UNF (m)	9/16"UNF (m)
Series 530	8530.700-55	without hose	9/16"UNF (m)	9/16"UNF (m)
Series 540	8540.700-55	without hose	9/16"UNF (m)	9/16"UNF (m)



■ In the twin hose the green one is provided with right hand thread. The red one is provided with left hand thread in order to avoid wrong connection.

INSTALLATION

The template supplied facilitates drilling of the holes and therefore hose reel fixing

The quick coupling adjustable support that enables 40° rotation to the right or left of the hose reel is available on request

The adjustable arms can be easily repositioned according to needs

Series	A	B	C	D	E	F	G	H	 1 ft³	 lb
430	7.3"	5.5"	7.7"	8.9"	4.5"	18.1"	16.5"	18.1"	3.0	41
530	8.0"	6.0"	8.6"	10.1"	4.5"	21.6"	20.0"	22.0"	5.0	51
540	11.8"	8.5"	8.9"	10.5"	7.4"	21.6"	20.0"	22.5"	6.2	67



SERIES 430 ABS



Applied
Lubrication
Technology Inc.

Hose reels with hoses in black synthetic rubber and zinc plated steel fittings.

The hose reels are equipped with a universal hose stop; those with hose are provided with a 2' inlet connection hose.

Swivel joint + Seals material	Version
Brass + Viton®	Air - Water
Stainless Steel + Viton®	Hot Water 1400 psi 3000 psi
Zinc Plated Steel + PU	Oil and Grease

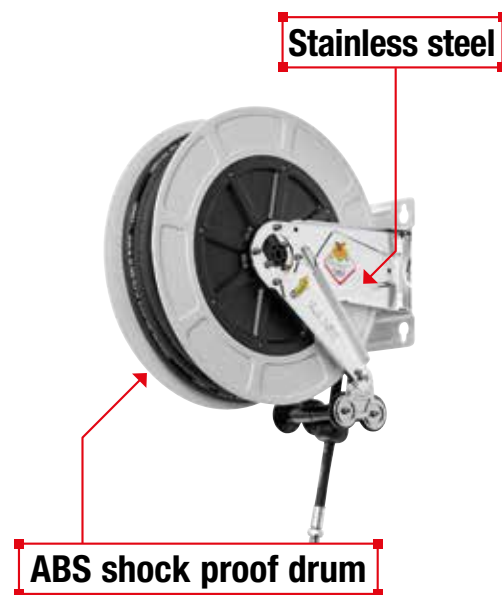
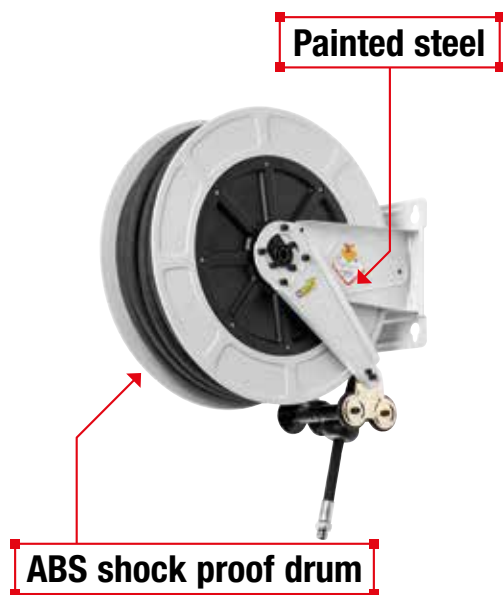

	P/N	Delivery hose			Inlet connection	Outlet connection
		ø	length	P/N hose		
Air - Water 300 psi	9430.100-55			without hose	1/2"NPSM (f)	1/2"NPSM (f)
	9430.101-55	3/8"	40'	995.211-55	1/2"NPSM (f)	3/8"NPTF (m)
	9430.102-55	3/8"	60'	995.217-55	1/2"NPSM (f)	3/8"NPTF (m)
	9430.103-55	1/2"	35'	996.210-55	1/2"NPSM (f)	1/2"NPSM (f)
	9430.104-55	1/2"	50'	996.215-55	1/2"NPSM (f)	1/2"NPSM (f)
Hot water 1400 psi	9430.200-55			without hose	1/2"NPSM (f)	1/2"NPSM (f)
	9430.201-55	1/2"	35'	996.311-55	1/2"NPTF (m)	1/2"NPTF (m)
	9430.202-55	1/2"	50'	996.316-55	1/2"NPTF (m)	1/2"NPTF (m)
Hot water 3000 psi	9430.300-55			without hose	3/8"NPSM (f)	3/8"NPSM (f)
	9430.301-55	3/8"	40'	995.512-55	3/8"NPTF (m)	3/8"NPSM (f)
	9430.302-55	3/8"	60'	995.518-55	3/8"NPTF (m)	3/8"NPSM (f)
Oil 2000 psi	9430.400-55			without hose	1/2"NPSM (f)	1/2"NPSM (f)
	9430.401-55	1/2"	35'	996.310-55	1/2"NPTF (m)	1/2"NPTF (m)
	9430.402-55	1/2"	50'	996.315-55	1/2"NPTF (m)	1/2"NPTF (m)
Grease 5800 psi	9430.500-55			without hose	3/8"NPSM (f)	3/8"NPSM (f)
	9430.501-55	1/4"	40'	993.511-55	3/8"NPTF (m)	1/4"NPTF (m)
	9430.502-55	1/4"	60'	993.518-55	3/8"NPTF (m)	1/4"NPTF (m)
	9430.505-55	3/8"	35'	995.710-55	3/8"NPTF (m)	1/4"NPTF (m)
	9430.506-55	3/8"	50'	995.715-55	3/8"NPTF (m)	1/4"NPTF (m)

	P/N	Delivery hose			Inlet connection	Outlet connection
		ø	length	P/N hose		
9432.100-55	9432.100-55			without hose	1/2"NPSM (f)	1/2"NPSM (f)
	9432.101-55	3/8"	40'	995.211-55	1/2"NPSM (f)	3/8"NPTF (m)
	9432.102-55	3/8"	60'	995.217-55	1/2"NPSM (f)	3/8"NPTF (m)
	9432.103-55	1/2"	35'	996.210-55	1/2"NPSM (f)	1/2"NPSM (f)
	9432.104-55	1/2"	50'	996.215-55	1/2"NPSM (f)	1/2"NPSM (f)
9434.200-55	9434.200-55			without hose	1/2"NPSM (f)	1/2"NPSM (f)
	9432.201-55	1/2"	35'	996.311-55	1/2"NPTF (m)	1/2"NPTF (m)
	9432.202-55	1/2"	50'	996.316-55	1/2"NPTF (m)	1/2"NPTF (m)
9434.300-55	9434.300-55			without hose	3/8"NPSM (f)	3/8"NPSM (f)
	9432.301-55	3/8"	40'	995.512-55	3/8"NPTF (m)	3/8"NPSM (f)
	9432.302-55	3/8"	60'	995.518-55	3/8"NPTF (m)	3/8"NPSM (f)

INSTALLATION

The template supplied facilitates drilling of the holes and therefore hose reel fixing

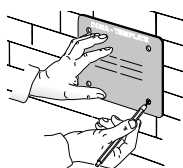

The quick coupling adjustable support that enables 40° rotation to the right or left of the hose reel is available on request

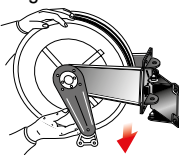

The adjustable arms can be easily repositioned according to needs

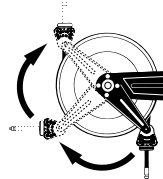

For installing several hose reels in series, follow the distance between bracket and bracket as per drawing in order to keep them aligned with eventual drip-catchers assembled underneath

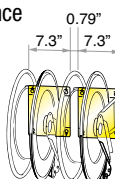

Series	A	B	C	D	E	F	G	H	1 ft³	lb
430	5.5"	7.3"	7.7"	8.9"	4.5"	18.1"	16.5"	18.1"	3.0	31 ÷ 44

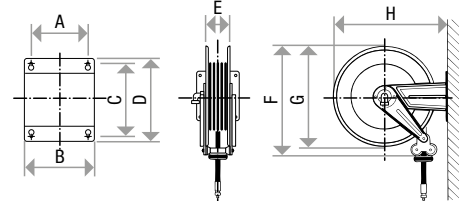



This series includes a range of enclosed hose reels designed to be used in those sectors that due to environmental conditions, technical or aesthetic reasons require enclosed hose reel application. S. 260 and S. 280 are both made in shock resistant ABS case. They are both equipped with polyurethane hose various sizes and length. 5' inlet hose is included. Outlet connection equipped with swivelling male thread.

SERIES 280 ABS ENCLOSED



SERIES 260 ABS ENCLOSED



	P/N	Delivery hose			Inlet connection	Outlet connection
		ø	length	P/N hose		
Air - Water 300 psi	92808.102-55	5/16"	46'	971.114-55	3/8"NPTF (m)	1/4"NPTF (m)
	92808.105-55	3/8"	26'+3'	972.109-55	3/8"NPTF (m)	3/8"NPTF (m)

	P/N	Delivery hose			Inlet connection	Outlet connection
		ø	length	P/N hose		
	89010-55	5/16"	36'	971.111-55	1/4"NPTF (m)	1/4"NPTF (m)

Packaging - Weight	No. 1 1.5 ft³ 15.4 ÷ 18.7 lb
--------------------	------------------------------

No. 1 0.9 ft³ 14 lb

P/N 89003-55

Bayonet bracket; it allows an easier hose movement of the reel in the various workstations



P/N 89001-55

Wall bracket; to buy separately in case you want to create multiple points for fitting the hose reel provided with bayonet bracket.



USES

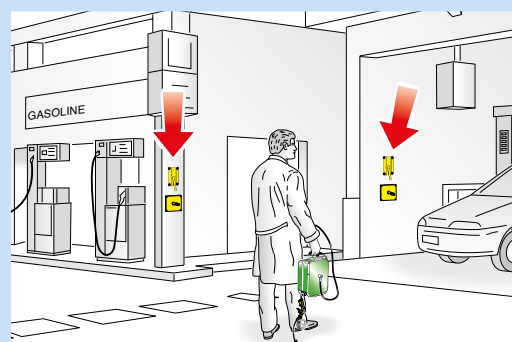

OVERALL DIMENSIONS inches

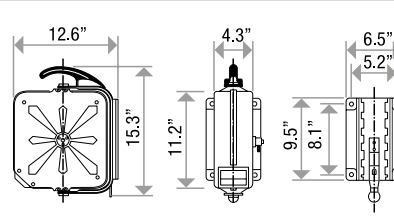
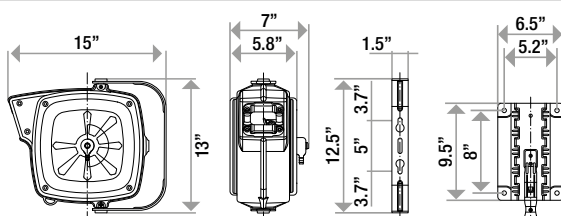



SERIES 450 ENCLOSED HOSE REELS



Applied
Lubrication
Technology Inc.

This series includes a range of enclosed hose reels, with painted steel carter, designed to be used in those sectors that due to technical or aesthetic reasons require enclosed hose reel application.



Swivel joint + Seals material	Version
Brass + Viton®	Air - Water Antifreeze
Painted Steel + PU	Oil and Grease

	P/N	Delivery hose			Inlet connection	Outlet connection
	PAINTED STEEL	Ø	length	P/N hose		
Air - Water - Antifreeze 300 psi	9450.100-55	without hose			1/2" NPSM (f)	1/2" NPSM (f)
	9450.101-55	3/8"	40'	995.211-55	1/2" NPTF (m)	3/8" NPTF (m)
	9450.102-55	3/8"	60'	995.217-55	1/2" NPTF (m)	3/8" NPTF (m)
	9450.103-55	1/2"	35'	996.210-55	1/2" NPTF (m)	1/2" NPTF (m)
	9450.104-55	1/2"	50'	996.215-55	1/2" NPTF (m)	1/2" NPTF (m)
Oil and similar 2000 psi	9450.400-55	without hose			1/2" NPSM (f)	1/2" NPSM (f)
	9450.401-55	1/2"	35'	996.310-55	1/2" NPTF (m)	1/2" NPTF (m)
	9450.402-55	1/2"	50'	996.315-55	1/2" NPTF (m)	1/2" NPTF (m)
Grease 5800 psi	9450.500-55	without hose			3/8" NPSM (f)	3/8" NPSM (f)
	9450.501-55	1/4"	40'	993.511-55	3/8" NPTF (m)	1/4" NPTF (m)
	9450.502-55	1/4"	60'	993.518-55	3/8" NPTF (m)	1/4" NPTF (m)
	9450.505-55	3/8"	35'	995.710-55	3/8" NPTF (m)	1/4" NPTF (m)
	9450.506-55	3/8"	50'	995.715-55	3/8" NPTF (m)	1/4" NPTF (m)
Packaging - Weight	No. 1 3.9 ft³ lb 42 ÷ 66					

EXAMPLE OF INSTALLATION

It is possible to fix wall bracket on different side according to needs

Standard installation

Wall installation

Bench installation

Ceiling installation

INSTALLATION

The template supplied facilitates drilling of the holes and therefore hose reel fixing

The adjustable arms can be easily repositioned according to needs

For installing several hose reels in series, follow the distance between bracket and bracket as per drawing in order to keep them aligned with eventual drip-catchers assembled underneath

OVERALL DIMENSIONS inches

18



Hose reels with hoses in black synthetic rubber and zinc plated steel fittings.

The hose reels are equipped with a universal hose stop; those with hose are provided with a 2' inlet connection hose.



SERIES 436 DEF



SERIES 537 DEF



P/N	Delivery hose			Inlet connection	Outlet connection
	Ø	length	P/N hose		
DEF 140 psi	8436.250-55	without hose		1" NPSM (f)	3/4" NPSM (f)
	8436.251-55	3/4"	35'	987.210-55	3/4" NPTF (m)
	8436.252-55	3/4"	50'	987.215-55	3/4" NPTF (m)

Packaging - Weight	No. 1 4.3 ft³ lb 42 ÷ 93
---------------------------	--------------------------

P/N	Delivery hose			Inlet connection	Outlet connection
	Ø	length	P/N hose		
8534.250-55	without hose			1" NPSM (f)	3/4" NPSM (f)

No. 1 4.2 ft³ lb 42

■ Hose reels for DEF, the fluid used in SCR systems which are present in new trucks, have been purposely designed by using stainless steel AISI 304 for those parts which get in contact with the fluid, avoiding in this way any contamination of the same fluid.

INSTALLATION

The template supplied facilitates drilling of the holes and therefore hose reel fixing

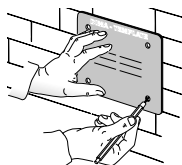

The quick coupling adjustable support that enables 40° rotation to the right or left of the hose reel is available on request

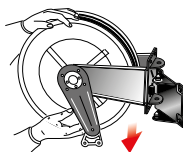

The adjustable arms can be easily repositioned according to needs

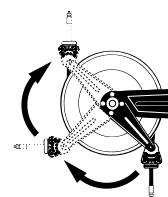

Series	A	B	C	D	E	F	G	H	1 ft³	lb
436	13.3"	11.9"	6.3"	8"	6.6"	17.7"	16.5"	18.1"	3.0	48 ÷ 66
534	8.0"	6.0"	8.6"	10.1"	4.5"	21.6"	20.0"	22.0"	4.2	68

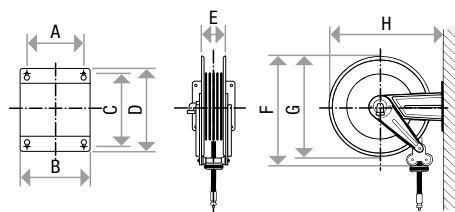



SERIES 350 GROUNDING REELS



Applied
Lubrication
Technology Inc.

Grounding reels
satisfies the need to
ground fuel tanks
during transferring
operation in order to
discharge electric
charges.



APPLICATIONS:
tanks and oil-refinery, aviation,
tank truck, boating.



P/N	Cable material	Insulation	Cable cross section	Cable length	Grounding clamp
735000-55	without cable	max cable capacity 98' - cross section 0.025 inches ²			
735131.60141-55	copper	PUR	0.009 inches ²	48'	antiexplosive 10A
735131.60261-55	copper	PUR	0.009 inches ²	85'	antiexplosive 10A
735131.60152-55	copper	PUR	0.009 inches ²	49'	standard 50A
735131.60252-55	copper	PUR	0.009 inches ²	82'	standard 50A
735141.60152-55	steel	PVC	0.28x0.28" Ø 0.20"	49'	standard 50A
735141.60252-55	steel	PVC	0.28x0.28" Ø 0.20"	82'	standard 50A

Operation:

Before begin fuel transfer operator must connect the grounding clamp, mounted at the end of the cable, to the grounding plate which is compulsory on every tank truck (Pic. A). As an alternative the grounding reel may be installed on the tank truck and the clamp connected to the grounding plate (Pic. B). Antiexplosive clamp, standard on some models below listed, may be installed in a potential explosive area (Zone 1) as specified in the CE declaration.

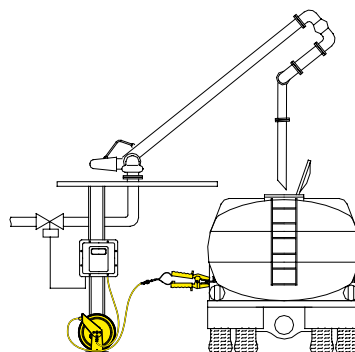

Pic. A

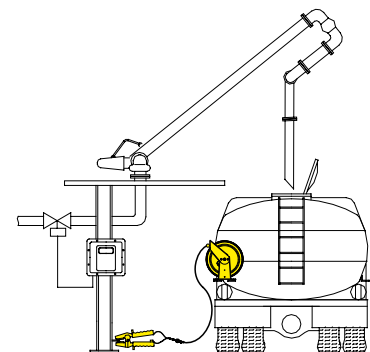

Pic. B

P/N 735111-55
Standard grounding
clamp 100A



OVERALL DIMENSIONS inches

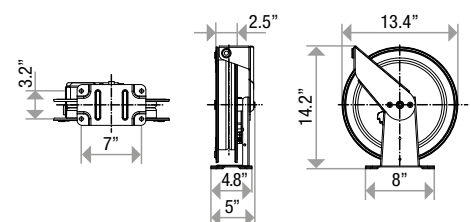

No.1 packing 1.6 ft³ from 23 to 25 lb



Applied
Lubrication
Technology Inc.

Hose reels equipped with hydraulic motor, suitable to rewind 1" or 1-1/2" hoses of various length (see page 109 for hose max rewinding length).

SERIES 617 HYDRAULIC



SERIES 637 HYDRAULIC



Swivel joint + Seals material	Version
Brass + Viton®	Air - Water Diesel fuel
Stainless Steel + Viton®	Hot water 1400 psi
Zinc Plated Steel + PU	Oil and Grease

P/N	Delivery hose		Inlet connection	Outlet connection
	Ø	length		

Air - Water 300 psi	8617.100-55	without hose	1"NPSM (f)	1"NPSM (f)
Hot water 1400 psi	8617.200-55	without hose	1"NPSM (f)	1"NPSM (f)
Oil and similar 2000 psi	8617.400-55	without hose	1"NPSM (f)	1"NPSM (f)
Grease 5800 psi	8617.500-55	without hose	1"NPSM (f)	1"NPSM (f)
Diesel fuel 140 psi	8617.600-55	without hose	1-1/2"NPSM (f)	1-1/2"NPTF (f)

P/N	Delivery hose		Inlet connection	Outlet connection
	Ø	length		

8637.100-55	without hose	1"NPSM (f)	1"NPSM (f)
8637.200-55	without hose	1/2"NPSM (f)	1/2"NPSM (f)
8637.400-55	without hose	1"NPSM (f)	1"NPSM (f)
8637.500-55	without hose	1"NPSM (f)	1"NPSM (f)
8637.600-55	without hose	1-1/2"NPSM (f)	1-1/2"NPSM (f)

WALL MOUNTING OF HYDRAULIC AND AIR MOTOR-OPERATED HOSE REELS

After choosing the ideal position, checking the consistency and thickness of the wall, marking the holes for the plugs (see template supplied with the hose reel) and making sure they do not interfere with hydraulic pipes or electrical wires, proceed with drilling. Fix the plugs in the wall and insert the hose reel in the special seats. Tighten the 4 fixing nuts.

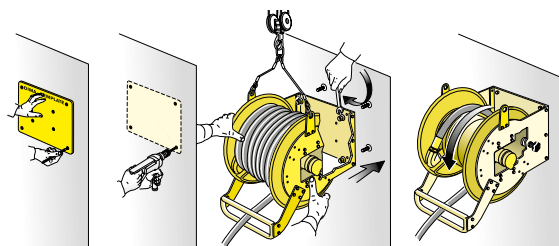

ASSEMBLY OF HOSE ON HYDRAULIC OR AIR MOTOR-OPERATED HOSE REELS WITH 1" CONNECTOR

Before carrying out the operation, make sure the hose reel drum is locked by means of the parking brake F. Screw one Nipple N on the outlet elbow G. Apply the hose on Nipple N.

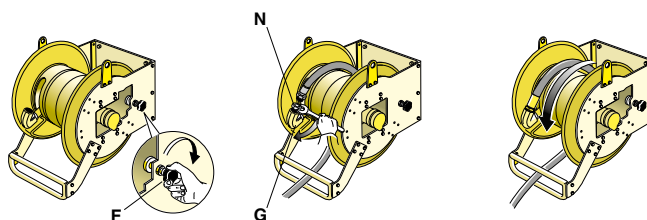

INSTALLATION

Series	A	B	C	D	E	F	G	H	1 ft³	lb
617	18.2"	27.2"	22.4"	24.4"	7.2"	5.5"	5.1"	12.2"	12.4	121 ÷ 125
637	25.5"	27.2"	22.4"	24.4"	14.6"	5.5"	5.1"	12.2"	0.473	165 ÷ 170

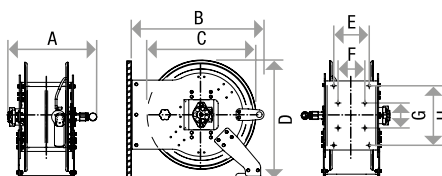

The adjustable arms can be easily repositioned according to needs

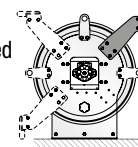



Hose reels equipped with air operated motor, suitable to rewind 1" hoses of various pressure and length (see page 109 for hose max rewinding length).

SERIES 618 PNEUMATIC



SERIES 638 PNEUMATIC



Swivel joint + Seals material	Version
Brass + Viton®	Air - Water Diesel fuel
Stainless Steel + Viton®	Hot water 1400 psi
Zinc Plated Steel + PU	Oil and Grease

	P/N	Delivery hose		Inlet connection	Outlet connection
		Ø	length		
Air - Water 300 psi	8618.100-55		without hose	1"NPSM (f)	1"NPSM (f)
Hot water 1400 psi	8618.200-55		without hose	1"NPSM (f)	1"NPSM (f)
Oil and similar 2000 psi	8618.400-55		without hose	1"NPSM (f)	1"NPSM (f)
Grease 5800 psi	8618.500-55		without hose	1"NPSM (f)	1"NPSM (f)
Diesel fuel 140 psi	8618.100-55		without hose	1"NPSM (f)	1"NPSM (f)

	P/N	Delivery hose		Inlet connection	Outlet connection
		Ø	length		
	8638.100-55		without hose	1"NPSM (f)	1"NPSM (f)
	8638.200-55		without hose	1"NPSM (f)	1"NPSM (f)
	8638.400-55		without hose	1"NPSM (f)	1"NPSM (f)
	8638.500-55		without hose	1"NPSM (f)	1"NPSM (f)
	8638.100-55		without hose	1"NPSM (f)	1"NPSM (f)

ASSEMBLY OF HOSE ON HYDRAULIC MOTOR-OPERATED HOSE REELS WITH 1-1/2" CONNECTOR

Before carrying out the operation, make sure the hose reel drum is locked by means of the parking brake F. Remove the outlet elbow G. Screw one Nipple N on the outlet elbow G. Apply the hose on Nipple N. Refit the outlet elbow G with the assembled parts.

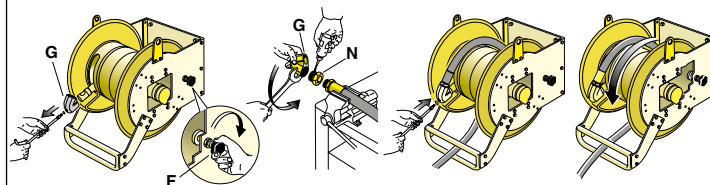

HYDRAULIC AND AIR MOTOR-OPERATED HOSE REEL FEED

The hydraulic motor-operated hose reels are fed, by an electric control unit (control and control unit not supplied). The air motor-operated hose reels are fed, by means of a control, with direct connection to the compressed air system (control not supplied).

■ HYDRAULIC HOSE REELS

Oil pressure max 2460 psi
at 1.32 gpm inlet feeding

■ PNEUMATIC HOSE REELS

Air pressure max 100 psi
at 70.6 cfm air consumption

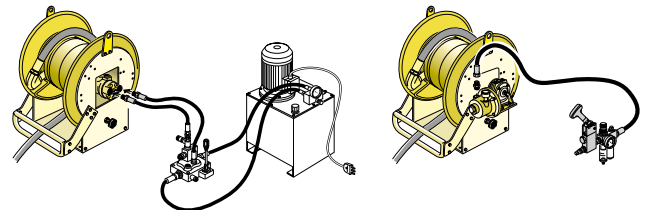

Series	A	B	C	D	E	F	G	H	1 ft³	lb
618	21.8"	27.2"	22.4"	24.4"	7.2"	5.5"	5.1"	12.2"	12.4	112 ÷ 115
638	29.1"	27.2"	22.4"	24.4"	14.6"	5.5"	5.1"	12.2"	16.7	156 ÷ 160

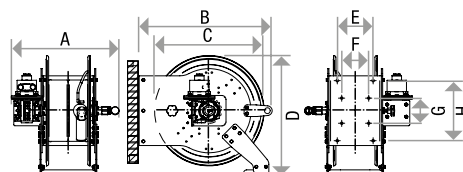

The adjustable arms can be easily repositioned according to needs

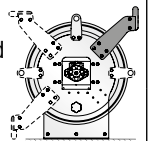

HOSE REELS ACCESSORIES

P/N 843005-55

Adjustable support in steel for fixed hose reels in painted steel series 290 - 330 - 390 - 430

P/N 843006-55

Adjustable support in AISI 304 stainless steel for fixed hose reels in stainless steel series 290 - 330 - 390 - 430

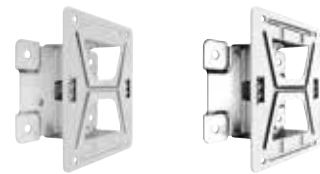
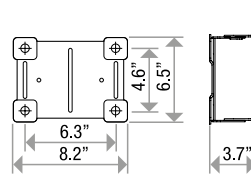

P/N 845005-55

Adjustable support in steel for fixed enclosed hose reels in painted steel series 450

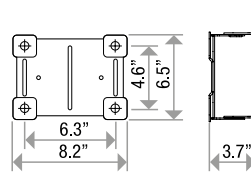

P/N 853005-55

Adjustable support in steel for fixed hose reels in painted steel series 530

P/N 853006-55

Adjustable support in AISI 304 stainless steel for fixed hose reels in stainless steel series 530

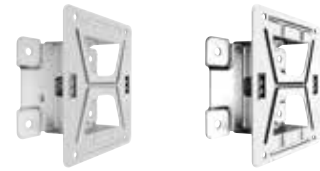
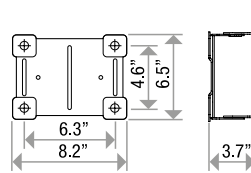

P/N 854005-55

Adjustable support in steel for fixed hose reels in painted steel series 540

P/N 854006-55

Adjustable support in AISI 304 stainless steel for fixed hose reels in stainless steel series 540

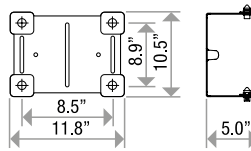

INSTALLATION WITH SWIVELLING BRACKET (AS OPTION)

The quick coupling adjustable support that enables 40° rotation to the right or left of the hose reel is available on request.

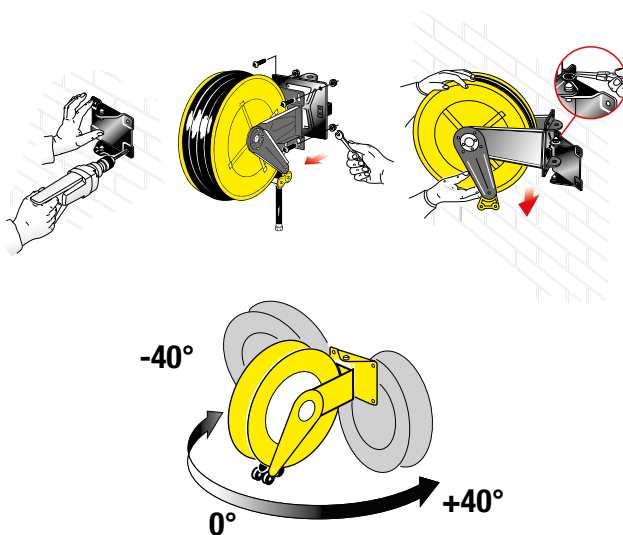



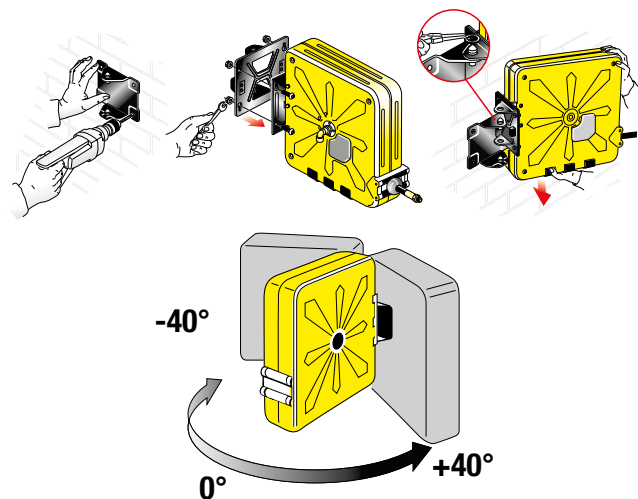





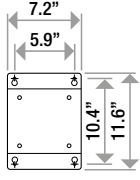

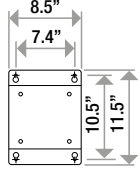
Series 290 - 330 - 390 - 430 - 530 - 540

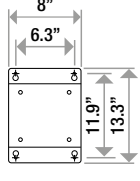

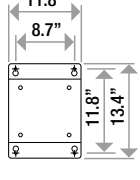
Series 450

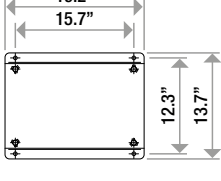
HOSE REELS ACCESSORIES





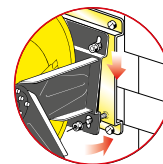
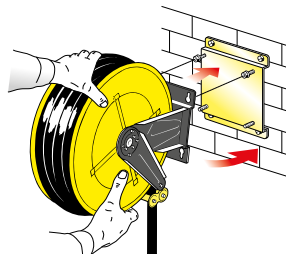
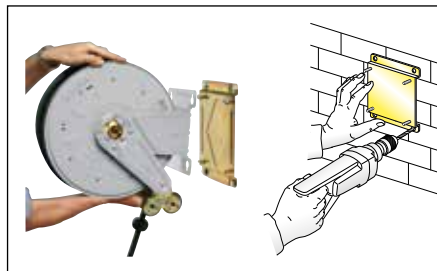

<p>P/N 843001-55 Fixed support in steel for fixed hose reels in painted steel series 290 - 330 - 390 - 430</p> <p>P/N 843002-55 Fixed support in AISI 304 stainless steel for fixed hose reels in AISI 304 stainless steel series 290 - 330 - 390 - 430</p>		
<p>P/N 845001-55 Fixed support in steel for fixed enclosed hose reels in painted steel series 450</p>		
<p>P/N 853001-55 Fixed support in steel for fixed hose reels in painted steel series 530</p> <p>P/N 853002-55 Fixed support in AISI 304 stainless steel for fixed hose reels in AISI 304 stainless steel series 530</p>		
<p>P/N 854001-55 Fixed support in steel for fixed hose reels in painted steel series 540</p> <p>P/N 854002-55 Fixed support in AISI 304 stainless steel for fixed hose reels in AISI 304 stainless steel series 540</p>		
<p>P/N 856001-55 Fixed support in steel for fixed hose reels in painted steel series 560</p> <p>P/N 856002-55 Fixed support in AISI 304 stainless steel for fixed hose reels in AISI 304 stainless steel series 560</p>		

QUICK COUPLING SUPPORT

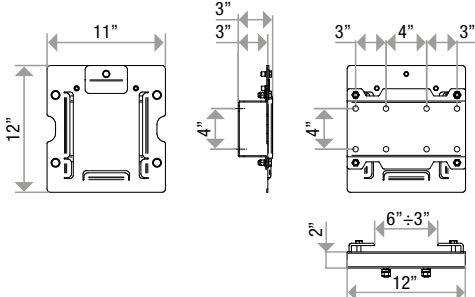

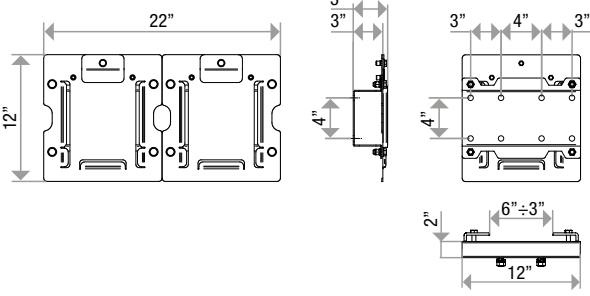
The **quick coupling support** that facilitates hooking of the single hose reel and optimises its installation in battery (i.e. with several hose reels side by side) is available by request

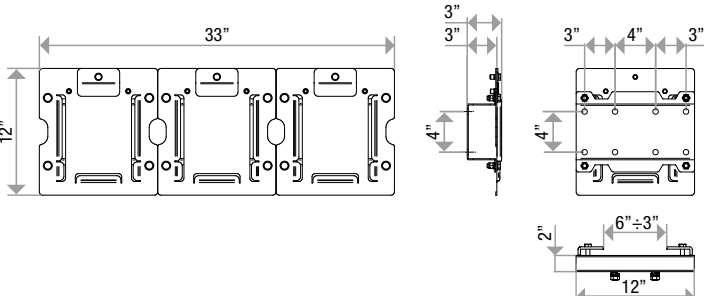
HOSE REELS ACCESSORIES

<p>P/N 843011-55 Special bracket to mount 1 hose reel series 390 or 430 on I beam</p>		
<p>P/N 843012-55 Special bracket to mount 2 hose reels series 390 or 430 on I beam</p>		
<p>P/N 843013-55 Special bracket to mount 3 hose reels series 390 or 430 on I beam</p>		

MOUNTING CHANNEL

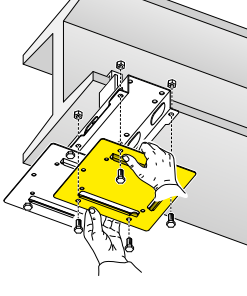

This special bracket allows ceiling installation on I beam for 1, 2 or 3 hose reels series 390 and 430.

Mounting channel can be mounted in 2 different position as shown on pictures 1 and 2

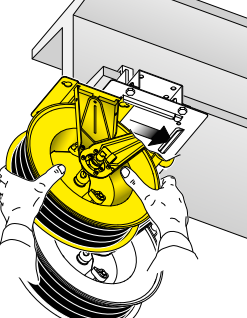

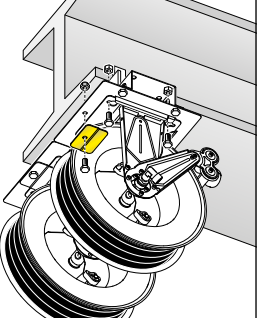

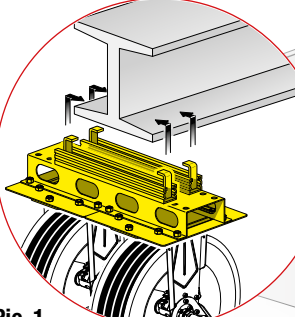

Pic. 1

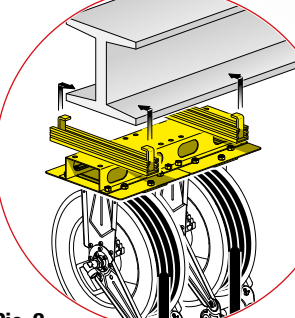

Pic. 2

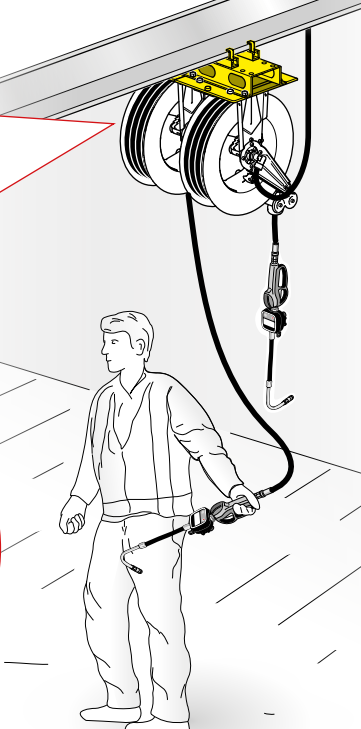

HOSE REELS ACCESSORIES

P/N 88630-55

Modular drip-tray. Equipped with hook for control handle and removable drip-tray. Applied under the hose reel, it is a handy holder for the delivery handle. Essential for a clean and orderly workplace.

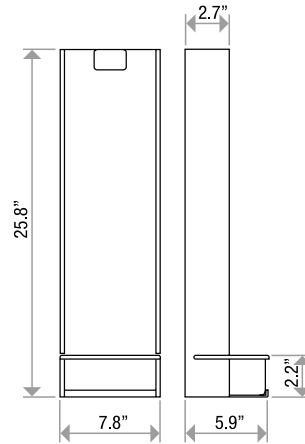

FITTING BSP (m/f) SWIVEL NPTF

- P/N 133838-55 carbon steel fitting 3/8" BSP (m) x 3/8" NPSM (f) swivel
- P/N 131238-55 carbon steel fitting 1/2" BSP (m) x 3/8" NPSM (f) swivel
- P/N 131212-55 carbon steel fitting 1/2" BSP (m) x 1/2" NPSM (f) swivel
- P/N 130112-55 carbon steel fitting 1" BSP (m) x 1/2" NPSM (f) swivel
- P/N 130134-55 carbon steel fitting 1" BSP (m) x 3/4" NPSM (f) swivel
- P/N 130101-55 carbon steel fitting 1" BSP (m) x 1" NPSM (f) swivel
- P/N 13112112-55 carbon steel fitting 1-1/2" BSP (m) x 1-1/2" NPSM (f) swivel
- P/N 233838-55 AISI 304 stainless steel fitting 3/8" BSP (m) x 3/8" NPSM (f) swivel
- P/N 231238-55 AISI 304 stainless steel fitting 1/2" BSP (m) x 3/8" NPSM (f) swivel
- P/N 231212-55 AISI 304 stainless steel fitting 1/2" BSP (m) x 1/2" NPSM (f) swivel
- P/N 230134-55 AISI 304 stainless steel fitting 1" BSP (m) x 3/4" NPSM (f) swivel
- P/N 230101-55 AISI 304 stainless steel fitting 1" BSP (m) x 1" NPSM (f) swivel



ADAPTOR (m/f) NPTF

- P/N 121438-55 carbon steel adaptor 1/4" NPTF (m) x 3/8" NPTF (f)
- P/N 123814-55 carbon steel adaptor 3/8" NPTF (m) x 1/4" NPTF (f)
- P/N 121234-55 carbon steel adaptor 1/2" NPTF (m) x 3/4" NPTF (f)
- P/N 123412-55 carbon steel adaptor 3/4" NPTF (m) x 1/2" NPTF (f)
- P/N 123401-55 carbon steel adaptor 3/4" NPTF (m) x 1" NPTF (f)
- P/N 12112114-55 carbon steel adaptor 1-1/2" NPTF (m) x 1-1/4" NPTF (f)
- P/N 1211201-55 carbon steel adaptor 1-1/2" NPTF (m) x 1" NPTF (f)
- P/N 1211234-55 carbon steel adaptor 1-1/2" NPTF (m) x 3/4" NPTF (f)



NIPPLE (m/m) NPTF

- P/N 111414-55 carbon steel nipple 1/4" NPTF (m) x 1/4" NPTF (m)
- P/N 111438-55 carbon steel nipple 1/4" NPTF (m) x 3/8" NPTF (m)
- P/N 113838-55 carbon steel nipple 3/8" NPTF (m) x 3/8" NPTF (m)
- P/N 111212-55 carbon steel nipple 1/2" NPTF (m) x 1/2" NPTF (m)
- P/N 111234-55 carbon steel nipple 1/2" NPTF (m) x 3/4" NPTF (m)
- P/N 113434-55 carbon steel nipple 3/4" NPTF (m) x 3/4" NPTF (m)
- P/N 113401-55 carbon steel nipple 3/4" NPTF (m) x 1" NPTF (m)
- P/N 110101-55 carbon steel nipple 1" NPTF (m) x 1" NPTF (m)



APPLICATION FIELDS

