



Series 238 - 50:1 - 3.3 lb/min



Series 238
air-operated pumps
for short/long distance
grease distribution, for
 high pressure greasing.
 Ideal for dispensing
 medium/high-viscosity
 grease. Suitable for
 mobile installations and
 centralized fixed systems.



P/N 62141-55

P/N 62148-55

P/N 62174-55

P/N 62195-55

Type of seals	polyurethane
Suction tube upper body	aluminum
Suction tube	carbon steel
Air inlet connection	1/4" NPT (f)
Grease outlet connection	1/4" NPT (f)
Cycles per lb	136
Air working pressure	90 - 120 psi
Max. air consumption 120 psi	26 cfm
Noise level	81 dB
Max. deliverable grease viscosity	NLGI 2
Suitable for drums	35 lb
Suction tube length	16"
Suction tube external diameter	ø 1.18"
Type of installations	for small drum
Packaging - Weight	No. 1 0.35 ft ³ 11 lb

Type of seals	polyurethane
Suction tube upper body	aluminum
Suction tube	carbon steel
Air inlet connection	1/4" NPT (f)
Grease outlet connection	1/4" NPT (f)
Cycles per lb	136
Air working pressure	90 - 120 psi
Max. air consumption 120 psi	26 cfm
Noise level	81 dB
Max. deliverable grease viscosity	NLGI 2
Suitable for drums	35 lb
Suction tube length	19"
Suction tube external diameter	ø 1.18"
Type of installations	for small drum
Packaging - Weight	No. 1 0.35 ft ³ 11 lb

Type of seals	polyurethane
Suction tube upper body	aluminum
Suction tube	carbon steel
Air inlet connection	1/4" NPT (f)
Grease outlet connection	1/4" NPT (f)
Cycles per lb	136
Air working pressure	90 - 120 psi
Max. air consumption 120 psi	26 cfm
Noise level	81 dB
Max. deliverable grease viscosity	NLGI 2
Suitable for drums	120 lb
Suction tube length	29"
Suction tube external diameter	ø 1.18"
Type of installations	suitable for drum 120 lb
Packaging - Weight	No. 1 0.52 ft ³ 14 lb

Type of seals	polyurethane
Suction tube upper body	aluminum
Suction tube	carbon steel
Air inlet connection	1/4" NPT (f)
Grease outlet connection	1/4" NPT (f)
Cycles per lb	136
Air working pressure	90 - 120 psi
Max. air consumption 120 psi	26 cfm
Noise level	81 dB
Max. deliverable grease viscosity	NLGI 2
Suitable for drums	400 lb
Suction tube length	37"
Suction tube external diameter	ø 1.18"
Type of installations	suitable for drum 400 lb
Packaging - Weight	No. 1 0.65 ft ³ 16 lb

USES

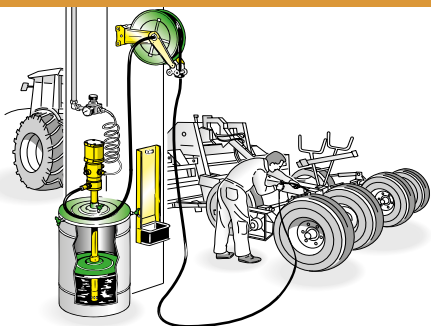

The pump suction tube is made with a combination of special, heat treated steel, without the use of seals in order to eliminate any problem of wear.

PUMP PERFORMANCE

- A** 116 psi
- B** 87 psi
- C** 58 psi

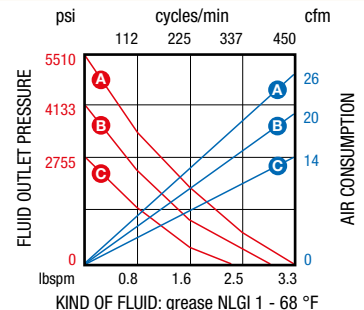



MOBILE DISPENSER KITS - 400 LB

Mobile grease Kits.

The ideal combination for dispensing grease in any workplace. The very easy to handle dolly is equipped with a drum (400 lb) clamping device, adjustable side support for hooking accessories, and wheel with brake. The mobile kit comes with a handy hose reel with 40' of hose. By request the mobile unit can be equipped with other hose reels (please contact the technical dept for more info).



P/N 64001-55

Mobile grease dispenser unit with hose reel,
for drums of 400 lb

Pump 50:1	62195-55
Heavy duty dolly	80210-55
Hose reel 1/4" - 40'	8430.501-55
Handle with triple swivel joint	66882-55
Hose	3/8" - 7' (995.702-55)
Drum cover ø 24"	65600-55
Follower plate ø 23"	66590-55
Packaging - Weight	No. 1 16.7 ft³ lb 177

P/N 64070-55

Mobile grease dispenser unit
for drums of 400 lb

	62195-55
	80200-55
	-
	66882-55
	1/4" - 13' (993.504-55)
	65600-55
	66590-55
	No. 1 4.27 ft³ lb 91.5

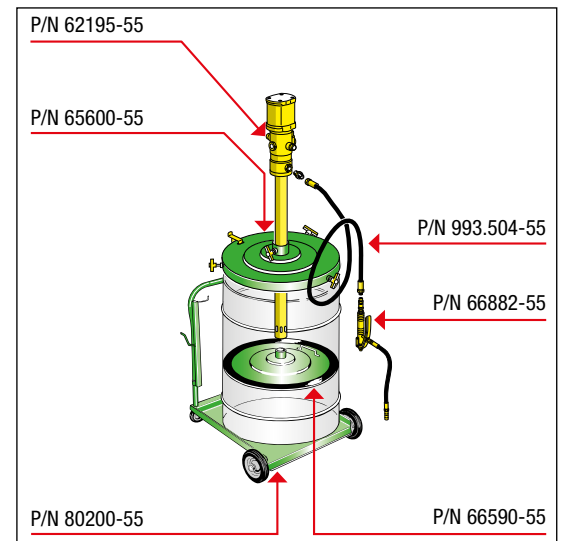
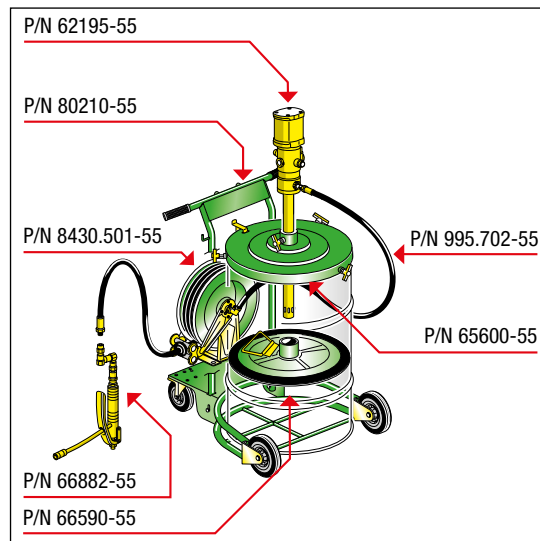



MOBILE DISPENSER KITS 35 LB - 120 LB



Dolly-mounted grease kit. The ideal combination for dispensing grease in any workplace. The compact dolly (P/N 80040-55) has 2 fixed wheels that make it very easy to handle. It is equipped with a pump support and is suitable for small-medium-size containers.



Ø 13"-15"



Ø 10"-12"



P/N 64039-55

Dolly-mounted grease dispenser kit,
for drums 120 lb, with external Ø 13" - 15"

P/N 64033/40-55

Dolly-mounted grease dispenser kit,
for drums 35 lb, with external Ø 10"-12"

Pump 50:1	62174-55
Dolly	80040-55
Handle with triple swivel joint	66882-55
Hose 1/4" - 13'	993.504-55
Drum cover	65385-55 (Ø 15.2")
Follower plate	66370-55 (Ø 14.6")
Packaging - Weight	No. 1 4.7 ft ³ 1 lb 46

	62148-55
	80040-55
	66882-55
	993.504-55
	65310-55 (Ø 12.2")
	66310-55 (Ø 12.2")
	No. 1 5.0 ft ³ 1 lb 40

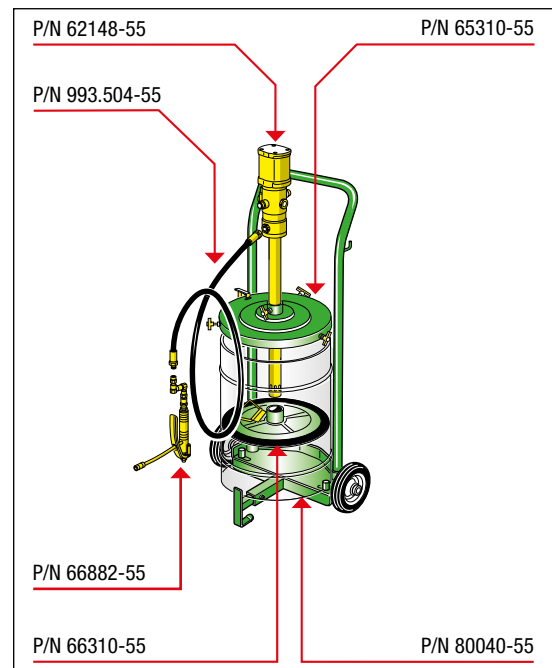
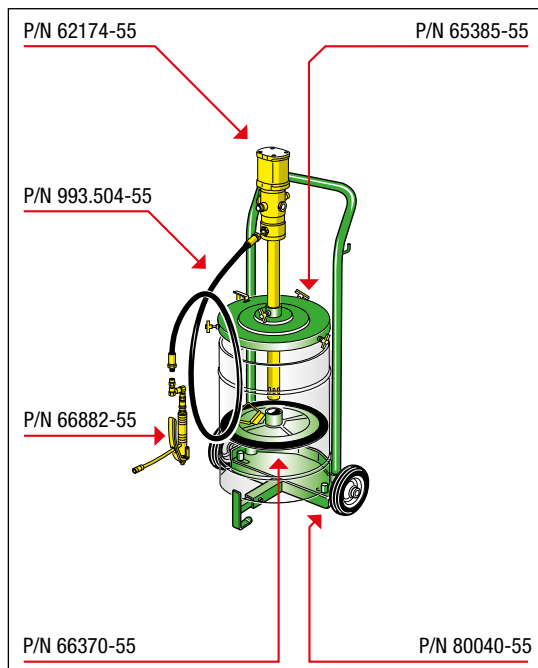



DISPENSER KITS 35 LB - 120 LB - 400 LB

Dispenser kit suitable for 35 - 120 - 400 lb drums. The ideal combination for dispensing grease in any workplace. The entirely galvanized dollies are also suitable for carrying 35 lb containers. Their compact size makes them very easy to handle and their modularity enables compact packing for easy transport and storage.



P/N 64031-55

Portable grease dispenser kit,
for drums 35 lb,
with external \varnothing 10"-12"

P/N 64143-55

Grease dispenser kit with pump
for drums 120 lb,
with external \varnothing 13"-15"

P/N 64194-55

Grease dispenser kit with pump
for drums 400 lb,
with external \varnothing 22" - 24"

Pump 50:1	62148-55
Handle with triple swivel joint	66882-55
Hose 1/4" - 13'	993.504-55
Kit carrying handle	66599-55
Drum cover	65310-55 (\varnothing 12.2")
Follower plate	66310-55 (\varnothing 12.2")
Packaging - Weight	No. 1 1.2 ft ³ lb 25

62174-55
66882-55
993.504-55
-
65385-55 (\varnothing 15.2")
66370-55 (\varnothing 14.6")
No. 1 1.4 ft ³ lb 37

62195-55
66882-55
993.504-55
-
65600-55 (\varnothing 23.6")
66590-55 (\varnothing 23.0")
No. 1 2.6 ft ³ lb 46

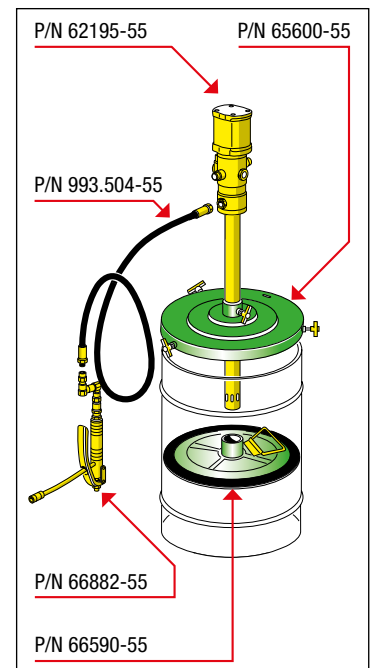
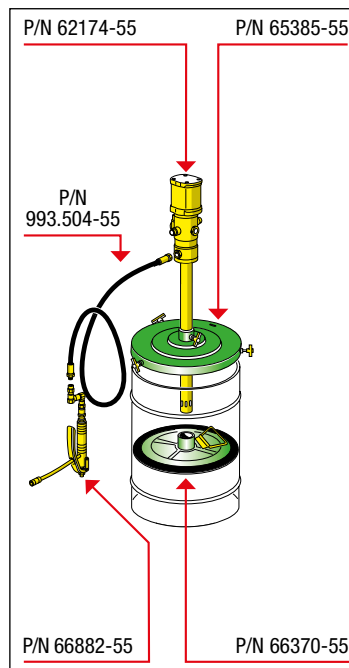
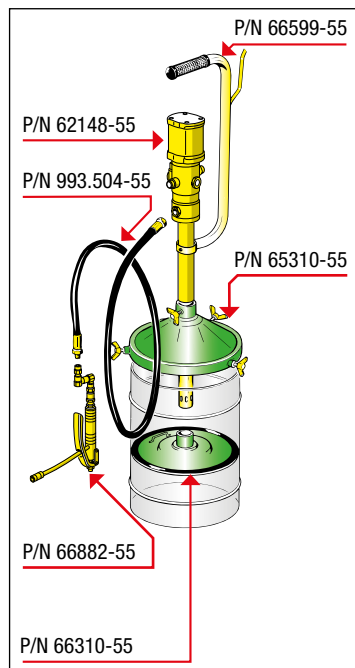



Series 234 - 65:1 - 4.2 lb/min

Series 234
air-operated pumps
for long distance
grease distribution,
for high pressure
greasing. Ideal for
dispensing medium/
high-viscosity grease.
Recommended when
delivery of a greater
quantity of grease with
high pressure is required.



P/N 63041-55

P/N 63048-55

P/N 63074-55

P/N 63095-55

Type of seals	polyurethane
Suction tube upper body	aluminum
Suction tube	carbon steel
Air inlet connection	1/4" NPT (f)
Grease outlet connection	1/4" NPT (f)
Cycles per lb	90
Air working pressure	90 - 120 psi
Max. air consumption 120 psi	42 cfm
Noise level	81 dB
Suitable for drums	35 lb
Suction tube length	16"
Suction tube external diameter	ø 1.18"
Type of installations	small drum
Packaging - Weight	No. 1 0.35 ft ³ 1b 13

Type of seals	polyurethane
Suction tube upper body	aluminum
Suction tube	carbon steel
Air inlet connection	1/4" NPT (f)
Grease outlet connection	1/4" NPT (f)
Cycles per lb	90
Air working pressure	90 - 120 psi
Max. air consumption 120 psi	42 cfm
Noise level	81 dB
Suitable for drums	35 lb
Suction tube length	19"
Suction tube external diameter	ø 1.18"
Type of installations	small drum
Packaging - Weight	No. 1 0.52 ft ³ 1b 13

Type of seals	polyurethane
Suction tube upper body	aluminum
Suction tube	carbon steel
Air inlet connection	1/4" NPT (f)
Grease outlet connection	1/4" NPT (f)
Cycles per lb	90
Air working pressure	90 - 120 psi
Max. air consumption 120 psi	42 cfm
Noise level	81 dB
Suitable for drums	120 lb
Suction tube length	29"
Suction tube external diameter	ø 1.18"
Type of installations	suitable for drum 120 lb
Packaging - Weight	No. 1 0.52 ft ³ 1b 16

Type of seals	polyurethane
Suction tube upper body	aluminum
Suction tube	carbon steel
Air inlet connection	1/4" NPT (f)
Grease outlet connection	1/4" NPT (f)
Cycles per lb	90
Air working pressure	90 - 120 psi
Max. air consumption 120 psi	42 cfm
Noise level	81 dB
Suitable for drums	400 lb
Suction tube length	37"
Suction tube external diameter	ø 1.18"
Type of installations	suitable for drum 400 lb
Packaging - Weight	No. 1 0.65 ft ³ 1b 18

USES

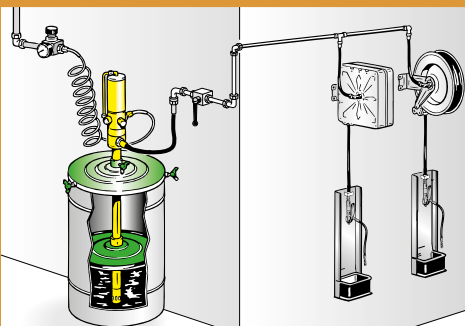

The pumps are equipped with a filter at the air inlet and a filter at the bottom of the suction tube grease inlet passage. They have a double valve enabling delivery of the grease in a continuous and constant flow. These devices prevent obstructions and consequent interruptions due to the passage of impurities.

PUMP PERFORMANCE

- A** 116 psi
- B** 87 psi
- C** 58 psi

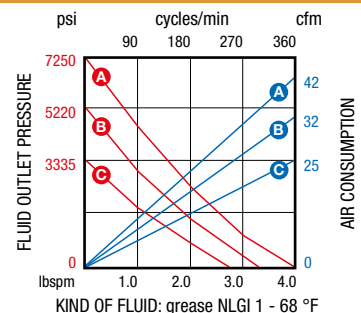



Series 600 - 70:1 - 15.4 lb/min

Series 600 industrial air-operated double-acting pumps suitable for transferring very high viscosity grease. The double-action guarantees the delivery of a continuous and constant flow. Particularly effective in systems equipped with multiple distribution points.



P/N 152F/701-55

P/N 153F/701-55

Type of seals	polyurethane
Suction tube upper body	aluminum - carbon steel
Suction tube	carbon steel
Air inlet connection	1/2" NPT (f)
Fluid outlet connection	1/2" NPT (f)
Air working pressure	90 - 120 psi
Noise level	80 dB
Max. deliverable grease viscosity *	NLGI 3
Cycles per lb	10.5
Max. air consumption 120 psi	176 cfm
Suction tube length	33.8"
Suction tube external diameter	2"
Type of installations	tank
Packaging - Weight	No. 1 7.0 ft ³ lb 70

Type of seals	polyurethane
Suction tube upper body	aluminum - carbon steel
Suction tube	carbon steel
Air inlet connection	1/2" NPT (f)
Fluid outlet connection	1/2" NPT (f)
Air working pressure	90 - 120 psi
Noise level	80 dB
Max. deliverable grease viscosity *	NLGI 3
Cycles per lb	10.5
Max. air consumption 120 psi	176 cfm
Suction tube length	23.6"
Suction tube external diameter	2"
Type of installations	tank
Packaging - Weight	No. 1 7.0 ft ³ lb 64

* At minimum working temperature of 59° F

TYPE OF INSTALLATIONS

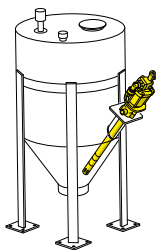

tank

PUMP PERFORMANCE

- A A**
116 psi
- B B**
87 psi
- C C**
58 psi

