



PUMP ELEVATORS

P/N 10/81-55
Single column pump elevator. Elevator is air operated and lifts pump assy via the side mounted 3-ways valve.

P/N 10/85-55
Air operated twin ram hoist for use with suitable industrial pumps are essential when pumping high viscosity and heavy materials. The pump and hoist are raised and lowered by compressed air via the side mounted 3-way valve for quick and easy drum changeovers. When used with a suitable follower plate (supplied separately), it ensures pump prime on the heaviest materials.



P/N 10/81-55

Single column industrial pump elevator.
Suitable for drums 400 lb

Column	1 without basement
Suitable for drums	400 lbs
Working temperature	35 °F - 104 °F
Max pressure	120 psi
Usable pumps	S. 234 - 238 - 312 - 412 - 600 - 700
Noise level	negligible (< 70 db)
Pushing force downwards at:	-
Basement accommodation pallet	-
Packaging - Weight	No. 1 24 ft ³ lb 166

P/N 10/85-55

Twin column industrial pump elevator and fluid press. Suitable for drums 400 lb

Column	2
Suitable for drums	400 lbs
Working temperature	35 °F - 104 °F
Max pressure	120 psi
Usable pumps	S. 234 - 238 - 312 - 412 - 600 - 700
Noise level	negligible (< 70 db)
Pushing force downwards at:	60 psi 950 lbs 90 psi 1427 lbs - 120 psi 1903 lbs
Basement accommodation pallet	11/101
Packaging - Weight	No. 1 65 ft ³ lb 408

OVERALL DIMENSIONS inches

■ P/N 10/81-55

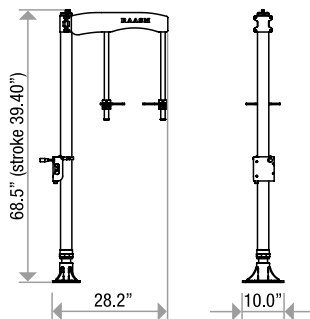

■ P/N 10/85-55

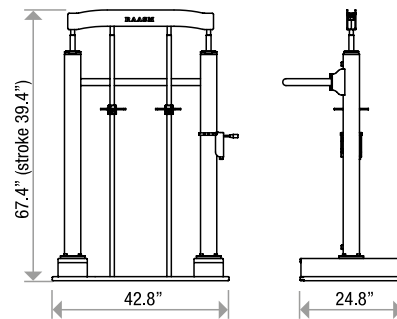



DETAILS AND ADVANTAGES

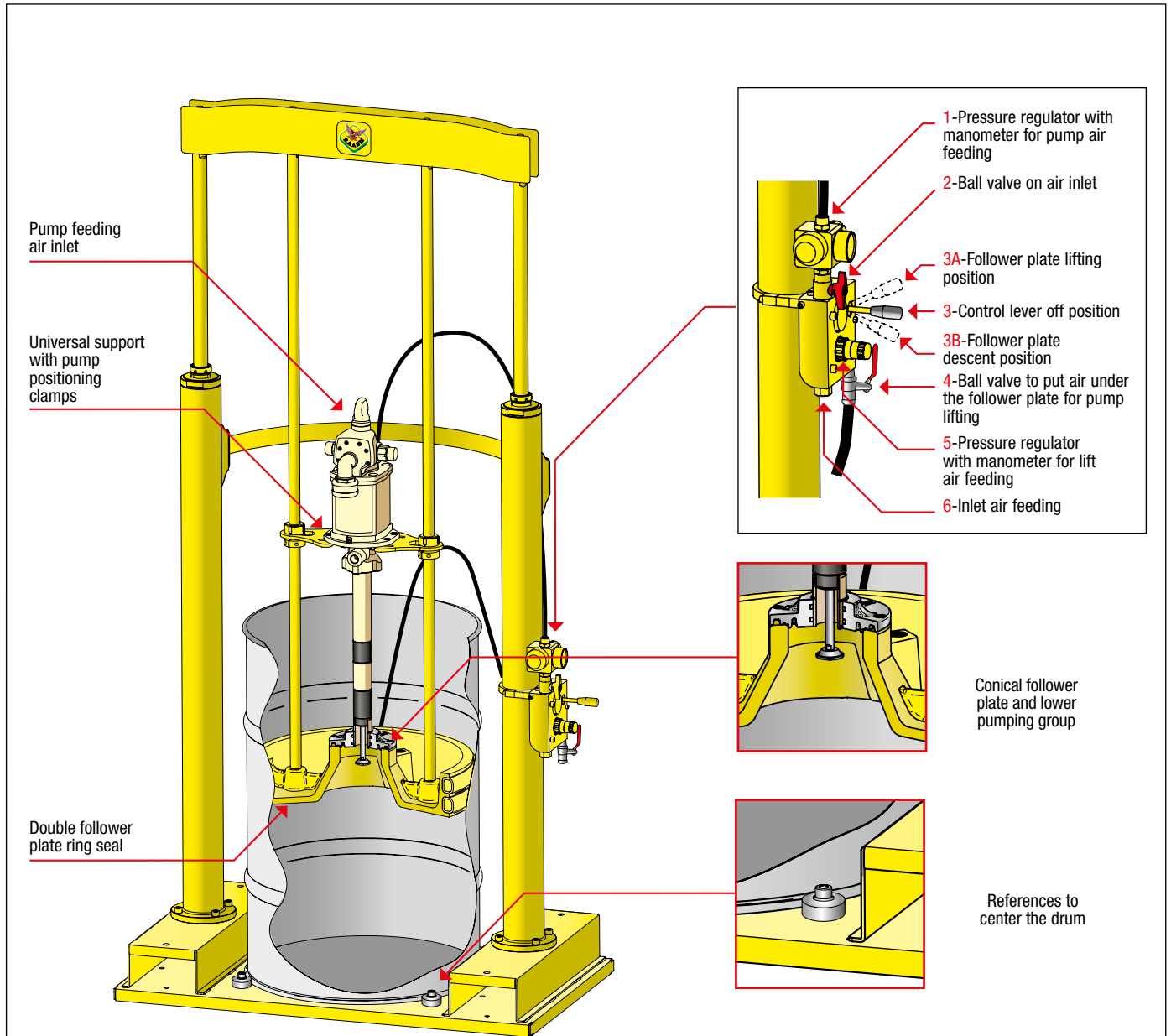

STANDARD BRACKETS

All the elevators are equipped with 2 standard brackets (A - B) suitable for mounting all our industrial pumps

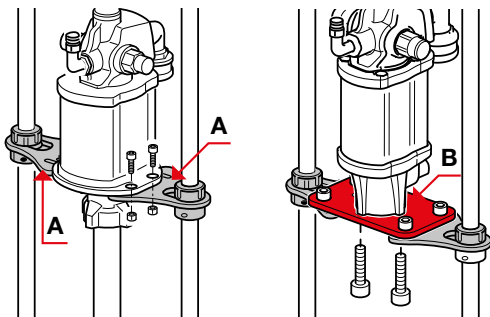

BRACKETS ON REQUEST

P/N 21/63-55 Special support suitable to mount pump with $\varnothing 1.18''$ suction tube

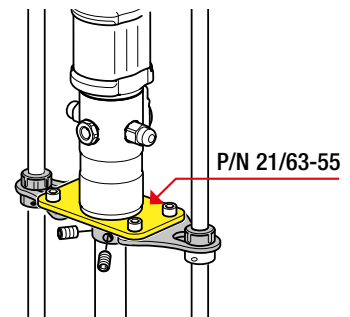



TWIN COLUMN RAM HOISTS

Air operated twin column ram hoist for use with industrial pump. Essential when pumping high viscosity and heavy fluids. It is raised and lowered by compressed air, via the side mounted 3-way valve. Follower plate ensures pump prime on high viscosity fluids since ram pushes down the follower plate helping pump to work. It is suitable for drums 400 lb.



P/N

10/12401P1N-55

Twin column ram hoist with:

- industrial pump P/N 118FSP/401-55
- follower plate P/N 11/65-55 for 400 lb drums

10/09451P1N-55

Twin column ram hoist with:

- industrial pump P/N 90FSP/451-55
- follower plate P/N 11/64-55 for 400 lb drums

10/12751P1N-55

Twin column ram hoist with:

- industrial pump P/N 115FSP/751-55
- follower plate P/N 11/64-55 for 400 lb drums

10/12181P1N-55

Twin column ram hoist with:

- industrial pump P/N 115F/181-55
- follower plate P/N 11/64-55 for 400 lb drums

10/09111P1N-55

Twin column ram hoist with:

- industrial pump P/N 90F/111-55
- follower plate P/N 11/64-55 for 400 lb drums

Twin column ram	P/N 10/85-55
Follower plate in NBR	P/N 11/60-55
Adaptor	P/N 21/65-55
Pump with seals in PU	P/N 118FSP/401-55
Ratio	40:1
Flow rate	22 lb/min
Suction tube	ø 2"
Pump connection hose	P/N 996.3015-55
Follower plate connection hose	P/N 995.301-55
Suitable for drums	400 lb
Packaging - Weight	No. 1 65 ft ³ lb 510

P/N 10/85-55
P/N 11/60-55
P/N 21/64-55
P/N 90FSP/451-55
45:1
9.7 lb/min
ø 1.77"
P/N 996.3015-55
P/N 995.301-55
400 lb
No. 1 65 ft ³ lb 500

P/N 10/85-55
P/N 11/60-55
P/N 21/64-55
P/N 115FSP/751-55
75:1
9.7 lb/min
ø 1.77"
P/N 996.3015-55
P/N 995.301-55
400 lb
No. 1 65 ft ³ lb 507

P/N 10/85-55
P/N 11/60-55
P/N 21/64-55
P/N 115F/181-55
18:1
42 lb/min
ø 1.77"
P/N 996.3015-55
P/N 995.301-55
400 lb
No. 1 65 ft ³ lb 491

P/N 10/85-55
P/N 11/60-55
P/N 21/64-55
P/N 90F/111-55
11:1
33 lb/min
ø 1.77"
P/N 996.3015-55
P/N 995.301-55
400 lb
No. 1 65 ft ³ lb 493



TWIN COLUMN RAM: CUSTOM KITS

In order to satisfy any particular need it is possible to create one's personalized kit choosing pump, follower plate, adaptors and support. We suggest you to look at the information explained in the following pattern.

1 TWIN COLUMN RAM						<p>Twin column ram and pump elevator suitable for 400 lb drums</p>
	P/N	10/85-55				

2 FOLLOWER PLATE						<p>Follower plates with NBR double o-rings. Equipped with connectors suitable for various sizes of down tube</p>	
	P/N	11/65-55	11/64-55	11/63-55	11/62-55		11/61-55
	Suitable for	ø 2" suction tube	ø 1.77" suction tube	ø 1.18" suction tube	2" (f) suction tube		1" (f) suction tube

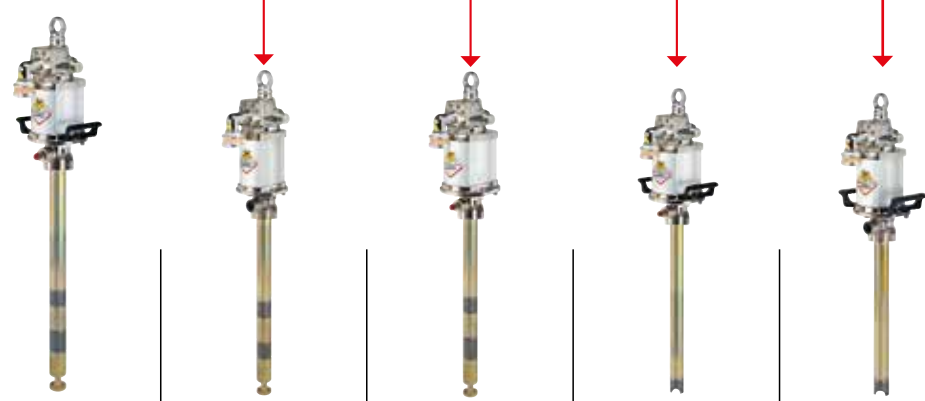
3 PUMPS						<p>Other pumps, here not listed, may be installed on the ram choosing the right follower plate (please contact the technical dept for more info)</p>	
	P/N	118FSP/401-55	90FSP/451-55	115FSP/751-55	115F/181-55		90F/111-55
	Series	412	312	412	412		312
	Ratio	40:1	45:1	75:1	18:1		11:1
	Flow rate	22 lb/min	9.7 lb/min	9.7 lb/min	42 lb/min		33 lb/min
	Seals	polyurethane	polyurethane	polyurethane	polyurethane		polyurethane
	Suct. tube	23.64"	19.70"	19.70"	19"		19"
P/N	10/12401P1N-55	10/09451P1N-55	10/12751P1N-55	10/12181P1N-55	10/09111P1N-55		



RAM HOISTS ACCESSORIES

P/N 11/61-55

Follower plate \varnothing 23" for 400 lb drums with NBR double ring seal and adaptor 1" (f)

P/N 11/62-55

Follower plate \varnothing 23" for 400 lb drums with NBR double ring seal and adaptor 2" (f)

P/N 11/63-55

Follower plate \varnothing 23" for 400 lb drums with NBR double ring seal and adaptor \varnothing 1.18"

P/N 11/64-55

Follower plate \varnothing 23" for 400 lb drums with NBR double ring seal and adaptor \varnothing 1.77"

P/N 11/65-55

Follower plate \varnothing 23" for 400 lb drums with NBR double ring seal and adaptor \varnothing 2"

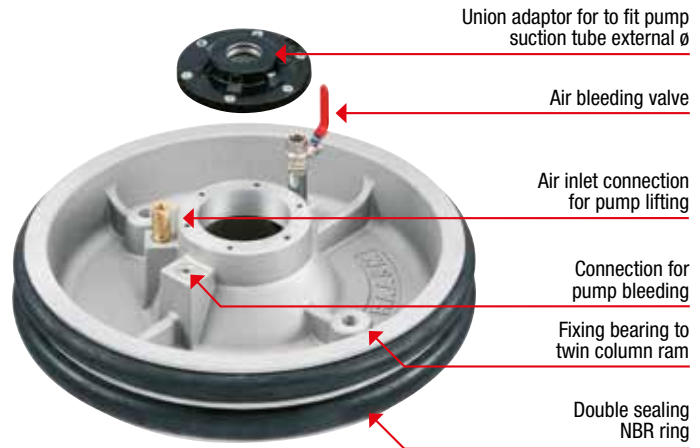

P/N 11/102-55

Visible air bleeder for ram hoist: eliminates air pockets inside the drum, leaving a clean follower plate



P/N 11/130-55

Pneumatic controls of the maximum and minimum drum's levels



P/N 21/63-55

Adaptor and o-rings for suction tube \varnothing 1.18". Special support suitable to mount on pump elevator.





Pump & Lift Packages for 8 - 30 Kg drums

alt Applied
Lubrication
Technology Inc.

